

CAUTION - THIS PROJECT REQUIRES CONSTRUCTION WORK IN, AROUND, AND OVER HAZARDOUS AND UNPROTECTED MINE SHAFTS, STOPS, ADITS, AND OTHER OPENINGS WHICH MAY BE OPEN TO THE SURFACE OR HIDDEN FROM VIEW BY TRASH, DEBRIS, OR THIN AND UNSTABLE LAYERS OF SURFACE MATERIALS OR ROCK. THE CONSTRUCTOR SHALL BE RESPONSIBLE FOR THOROUGHLY INVESTIGATING THE SITE CONDITIONS AND SCHEDULING HIS EQUIPMENT, EQUIPMENT OPERATIONS, PERSONNEL, AND SAFETY PROCEDURES TO PREVENT ACCIDENTS AND INJURIES.

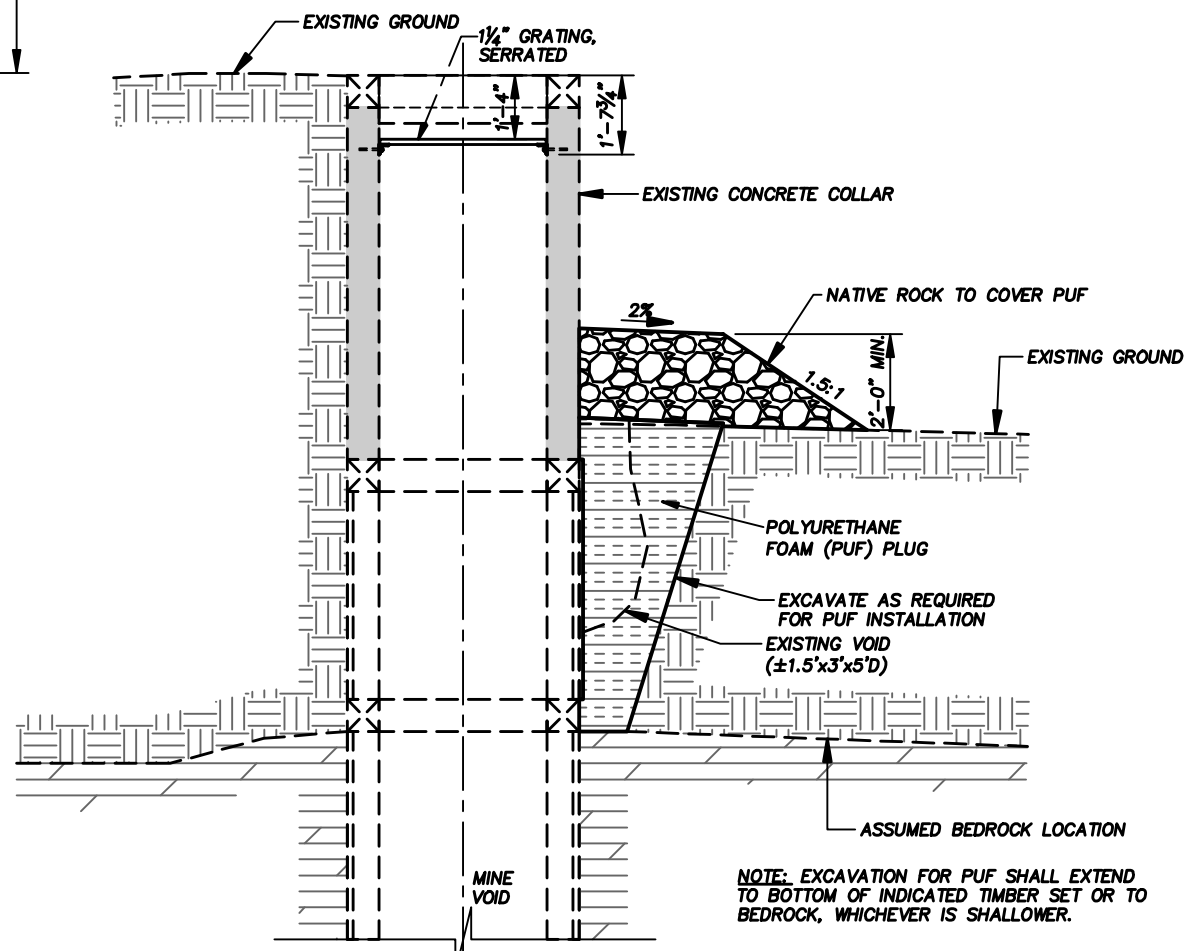
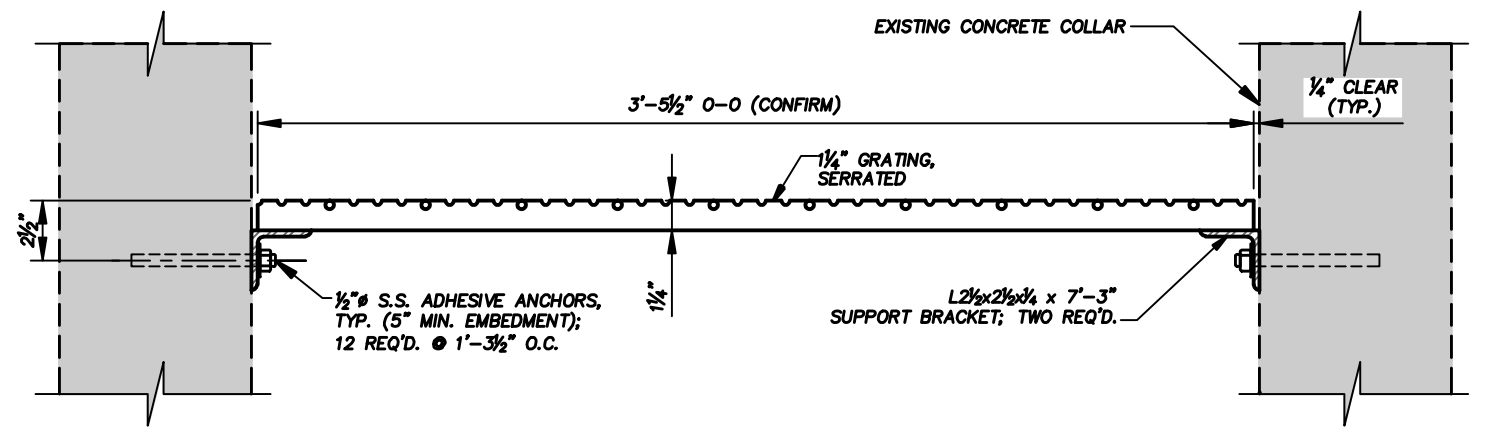
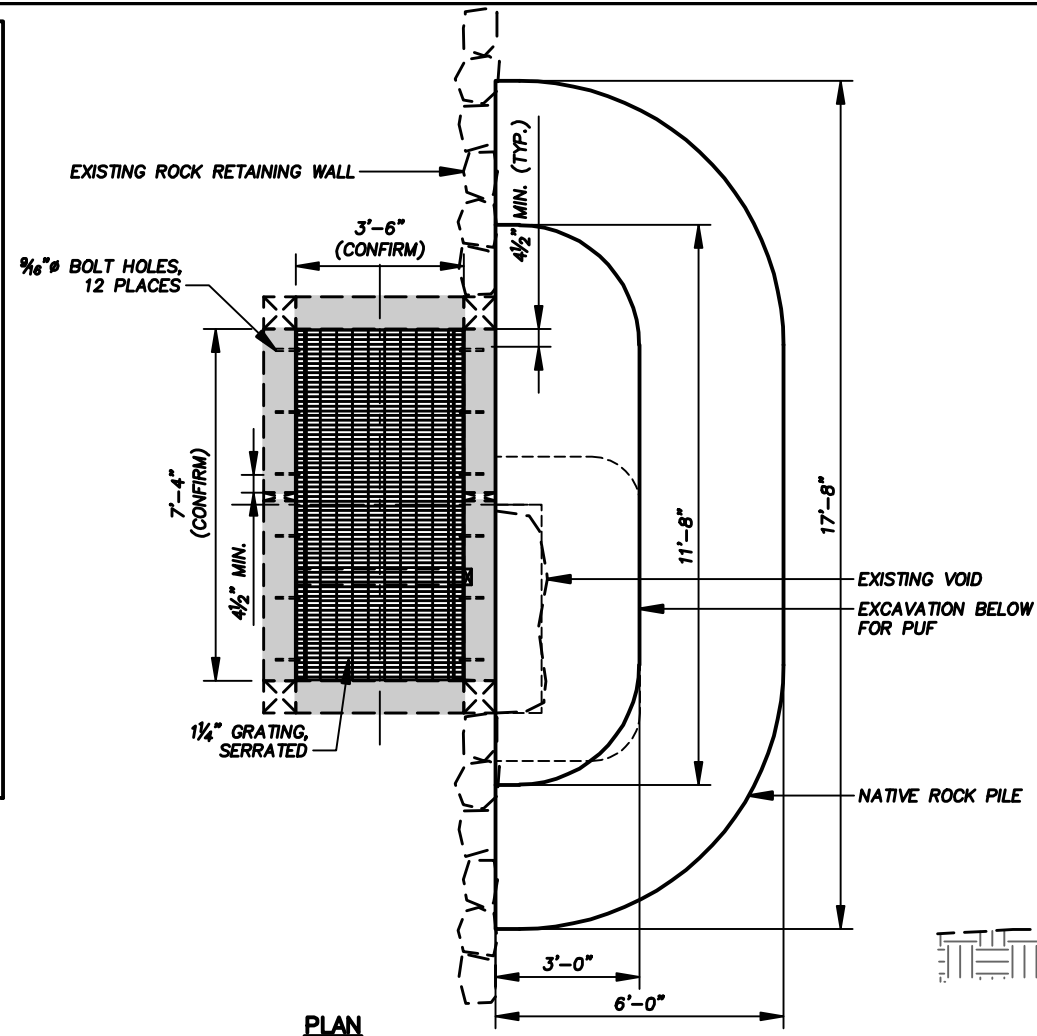

- GENERAL NOTES:**
1. THIS DRAWING SHOWS THE GENERAL SHAPE AND APPROXIMATE SIZE OF THE MINE OPENING AND THE CORRESPONDING LAYOUT OF THE AIRFLOW CLOSURE. THE DRAWING SHALL BE USED AS A GUIDE FOR FIELD LAYOUT. DETERMINE THE ACTUAL LAYOUT AND DIMENSIONS OF THE CLOSURE IN THE FIELD PRIOR TO FABRICATION.
 2. USING A COMPRESSED AIR LANCE OR EQUIVALENT, REMOVE DIRT AND LOOSE ROCK FROM ROCK SURFACES AGAINST WHICH POLYURETHANE FOAM (PUF) WILL BE PLACED. PLACE PUF AGAINST CLEAN, DRY SURFACES.
 3. THE INDICATED BEDROCK LOCATIONS ARE APPROXIMATE. THE BEDROCK SURFACE IS EXPECTED TO BE ROUGH, IRREGULAR AND VARIABLE IN DEPTH. EXCAVATION FOR PUF SHALL EXTEND TO BOTTOM OF INDICATED TIMBER SET OR TO COMPETENT BEDROCK, WHICHEVER IS SHALLOWER.
 4. STAINLESS STEEL ADHESIVE ANCHORS SHALL BE HILTI 'HAS' ANCHOR RODS, WILLIAMS 'S6S' CAPSULE ANCHORS, OR EQUIVALENT.
 5. TACK WELD GRATING TO SUPPORT BRACKETS AS SPECIFIED.
 6. MINIMIZE THE AMOUNT OF ROCK, TIMBER AND OTHER DEBRIS THAT FALL INTO THE MINE OPENING DURING CONSTRUCTION.
 7. REMOVE LADDER TIMBERS NEAR SURFACE AS NECESSARY.
 8. EXISTING TIMBER HEADFRAME AND LOADOUT STRUCTURE ARE TO BE PRESERVED AS MUCH AS PRACTICABLE. NEITHER HAVE BEEN SHOWN TO PROVIDE DRAWING CLARITY.
 9. FOR CLARITY, NOT ALL COLLAR TIMBERS ARE SHOWN. REMOVE TIMBERS ONLY AS NECESSARY FOR CONSTRUCTION.
 10. USE APPROPRIATE SAFETY MEASURES AND PROCEDURES WHILE WORKING NEAR OR UNDER THE EXISTING HEADFRAME AND LOADOUT.
 11. N.B. THERE IS EXTENSIVE TIMBER WORK IN THE MINE WORKINGS BELOW THIS SHAFT OPENING. THE TIMBER IS EXTREMELY DRY AND EASY TO SET ON FIRE. EXTREME PRECAUTION SHALL BE TAKEN TO PREVENT ANY SPARKS FROM WELDING OR OTHER ACTIVITIES FROM FALLING INTO THE SHAFT.

ABANDONED MINE LAND PROGRAM MINING AND MINERALS DIVISION			
ENERGY, MINERALS AND NATURAL RESOURCES DEPARTMENT			
SCALE: AS SHOWN	N. CAROLINA LODE (OFFICE SHAFT)		DRAWN BY: JAK/JRS
DATE: OCT. 10, 2006			REVISED:
AIRFLOW CLOSURE AT FEATURE 046-133S SHAFT			
LAKE VALLEY MINE SAFEGUARD PROJECT - PHASE II			DRAWING NUMBER: FIGURE 27