

PLAN OF OPERATIONS
for Magnesium Mining
Deming, New Mexico

Prepared for:
U.S. DEPARTMENT OF THE INTERIOR
BUREAU OF LAND MANAGEMENT
Las Cruces Field Office



PLAN OF OPERATIONS

*for Magnesium Mining
Deming, New Mexico*

March 2017

Prepared for:



U.S. DEPARTMENT OF THE INTERIOR

**BUREAU OF LAND MANAGEMENT – Las Cruces
Field Office**

Submitted by:

American Magnesium, LLC
104 Rinconada
P.O. Box 684
Elephant Butte, New Mexico 87935



Prepared by:



Amec Foster Wheeler Environment & Infrastructure, Inc.
8519 Jefferson NE
Albuquerque, NM 87113

EXECUTIVE SUMMARY

This Plan of Operations (PoO) is submitted to the Bureau of Land Management, Las Cruces Office (BLM), and the New Mexico Energy, Minerals and Natural Resources Department (EMNRD) Mining and Minerals Division (MMD) by Amec Foster Wheeler, Environment & Infrastructure, Inc. (Amec Foster Wheeler) for the American Magnesium Resource Verification and Mining Project (Project) located near Deming, New Mexico. The Project is administered by American Magnesium LLC (AmMg), a New Mexico limited liability company. As outlined in Section 1.1 of this Plan, AmMg will be the operator. This PoO is submitted in accordance with BLM Surface Management Regulations 43 Code of Federal Regulations (CFR) 3809, as amended, and New Mexico Mining Act Reclamation Program regulations at New Mexico Administrative Code (NMAC) 19.10.3. This PoO is intended both to satisfy the BLM's requirements for a plan of operations and to supplement and support AmMg's corresponding application to MMD for a Subpart 3 minimal impact new mining operations permit for mining development and reclamation.

The Project is located on public lands administered by the BLM in part or all of Sections 26 & 27, Township 25 South, Range 8 West, NMPM, in the Little Florida Mountains Mining District, Luna County, New Mexico (Project Area). The Project Area includes approximately 44 acres. Project disturbance and bonding will occur in phases. There are approximately 8.6 miles of existing road that will be utilized for Project access. Figure 1 shows the Project Area. Figure 2 shows the proposed Phase I Project access roads within the Project Area.

AmMg proposes to create, over the life of the project, a total of 44 acres of surface disturbance under this PoO. At any given time during the project, however, there will be no more than 40 un-reclaimed acres of disturbance. All 44 acres of anticipated total new disturbance will be analyzed as required under the National Environmental Policy Act. The mineral resource verification activities covered under this Plan consist of the following: drilling reverse circulation and core holes, blasting operations, geologic and geophysical mapping, construction of resource verification roads, drill sites, and sumps, maintenance of the existing roads within the Project Area and the Project access roads and reclamation of Project-related surface disturbance.

Table 1 outlines the total acreage of authorized and proposed surface disturbance, by type of disturbance. The proposed disturbance under Phase I will create a total of approximately 15 acres of new surface disturbance. The remaining surface disturbance acreage (29 acres) will be utilized through resource verification under subsequent phases over approximately five years. These phased activities will consist of the same type of activities as in the PoO, but the locations will be submitted as work plans to the BLM. The locations will be based on the success of previously completed resource verification activities. The work plans will include maps that show the location of the proposed surface disturbance to ensure that all

listed and eligible and unevaluated cultural resources or any other sensitive resources are avoided.

Table 1: Acreage of Approved and Proposed Project Disturbance

Surface Disturbing Activity	Disturbance		
	Proposed Phase I (acres)	Subsequent Phases (acres)	Total (acres)
Constructed Roads	0.5	0.5	1.0
Overland Travel	1.0	2.0	3.0
Drill Sites (Pads)	13.0	26.0	39.0
Existing Access Road Needing Rehabilitation	0.5	0.5	1.0
TOTAL*	15.0	29.0	44.0

*No more than 40 acres of disturbance will occur at one time. The mining development project will be phased to reduce the amount of surface disturbance and incorporate rolling reclamation into the project.

Table 2: Bonding for Existing and Proposed Disturbance under Phase I

Proposed Phase I Acres	Total Bonded Disturbance Acres
15.0	44.0

This page intentionally left blank

TABLE OF CONTENTS

	Page
EXECUTIVE SUMMARY.....	i
ACRONYMS AND ABBREVIATIONS	viii
1.0 APPLICANT INFORMATION [3809.401(B)(1)]	1-1
1.1 Operator Information	1-1
1.2 Claims Information	1-1
1.3 Individual Completing Application.....	1-1
1.4 Business Information	1-2
1.5 Corporation Information	1-2
1.6 Partnership Information	1-2
2.0 DESCRIPTION OF OPERATIONS – PROPOSED ACTION [3809.401(B)(2)]	2-1
2.1 Legal Description [3809.401(b)(2)(i)]	2-1
2.2 Project Access	2-1
2.3 Site Ownership (Acres) and Land Status within the Proposed Project Area.....	2-1
2.4 Description of Proposed Action and Site Conceptual Design [3809.401(b)(2)(ii)].....	2-1
2.5 Proposed Equipment [38.09.401(b)(2)ii].....	2-3
2.6 Operating Practices [3809.401(b)(2)ii].....	2-4
2.7 Mining Operations and Ancillary Facilities.....	2-5
2.8 Site Access and Proposed Constructed Roads	2-5
2.9 Use and Occupancy	2-6
2.9.1 Proposed Temporary and Permanent Structures	2-7
2.9.2 Access Restrictions to Mining Site	2-7
2.9.3 Estimated Duration for Use of On-site Structures	2-7
2.10 Hazardous Materials (Hazmat)	2-8
2.11 Spill Prevention Plan [3809.401(b)(2)(vi)]	2-8
2.12 Project-specific Quality Assurance Plan [3809.401(b)(2)(v)]	2-9
2.13 Water Use and Management [3809.401(b)(2)(iii)]	2-9
2.14 Environmental Protection Measures	2-9
2.14.1 Water Quality	2-10
2.14.2 Air Quality	2-10
2.15 Site Geology.....	2-10
2.15.1 Hydrology	2-11
2.15.2 Soils.....	2-11
2.15.3 Vegetation	2-12
2.15.3.1 Noxious Weeds.....	2-13
2.15.4 Cultural and Paleontological Resources.....	2-13
2.15.5 Wildlife	2-16
2.15.6 Migratory Birds.....	2-16

2.15.7	Public Safety and Site Access	2-17
2.15.8	Socioeconomic Conditions in and Around the Proposed Project Area	2-17
2.15.8.1	Population.....	2-18
2.15.8.2	Housing.....	2-19
2.16	Proposed Preliminary Schedule of Operations (Concept to Closure).....	2-19
2.17	Other Plans and Requirements	2-19
3.0	RECLAMATION PLAN [3809.41(B)(3)]	3-1
3.1	Mine Reclamation [3809.401(b)(3)(ii)]	3-1
3.2	Regrading and Reshaping of 40-Acre Disturbed Area [3809.401(b)(3)(ii)].....	3-2
3.3	Revegetation [3809.401(b)(3)(vii)].....	3-2
3.4	Wildlife Rehabilitation [3809.401(b)(3)(v)]	3-3
3.5	Removal of Building and Associated Structures [3809.401(b)(3)(ix)].....	3-3
3.6	Post-Closure Management [3809.401(b)(3)(x)].....	3-3
3.7	Project Maps	3-3
3.8	Proposed Productive Post-Mining Land Use	3-7
4.0	MONITORING PLAN [3809.401(B)(4)]	4-1
4.1	Monitoring Devices.....	4-1
4.2	Sampling Parameters and Frequency	4-1
4.3	Analytical Methods	4-1
4.4	Reporting Procedures	4-2
5.0	INTERIM MANAGEMENT PLAN [3809.401(B)(5)]	5-1
5.1	Schedule of Anticipated Periods of Temporary Closure [3809.401(b)(5)(vi)]5-1	
5.2	Plans for Monitoring Site Conditions during Periods of Non-Operation [3809.401(b)(5)(v)]	5-1
5.2.1	Measures to Stabilize Excavations and Workings [3809.401(b)(5)(i)]5-1	
5.2.2	Measures to Isolate or Control Toxic or Deleterious Materials [3809.401(b)(5)(ii)]	5-1
5.2.3	Provisions for the Storage or Removal of Equipment, Supplies, and Structures [3809.401(b)(5)(iii)]	5-2
5.2.4	Measures to Maintain the Project Area in a Safe and Clean Condition [3809.401(b)(5)(iv)]	5-2
6.0	RECLAMATION COST ESTIMATE [3809.401(D)]	6-1
7.0	REFERENCES.....	7-1

LIST OF TABLES

Table 1: Acreage of Approved and Proposed Project Disturbance.....	ii
Table 2: Bonding for Existing and Proposed Disturbance under Phase I.....	ii
Table 3. Complete List of Plant Species Observed in the Project Area.....	2-12
Table 4. Isolated Occurrences Found During the Inventory	2-14
Table 5. Complete List of Wildlife Species Observed in the Project Area.....	2-16
Table 6. Population Change, 2000-2010.....	2-18
Table 7. Population Under 18 Years of Age, 2010.....	2-18
Table 8. Distribution of Population by Age, 2010.....	2-18
Table 9. Preliminary Reclamation Cost Estimate	6-1

LIST OF FIGURES

Figure 1. Project Location.....	3-4
Figure 2. Site Access.....	3-5
Figure 3. Land Management Agency.....	3-6
Figure 4. Claim Boundaries	3-7

LIST OF APPENDICES

APPENDIX A - SPILL PREVENTION PLAN (TO BE PROVIDED)
APPENDIX B - SOIL SURVEY OF LUNA COUNTY, NM
APPENDIX C - ARCHAEOLOGICAL AND BIOLOGICAL SURVEY
APPENDIX D - RECLAMATION COST (TO BE PROVIDED)

This page intentionally left blank

ACRONYMS AND ABBREVIATIONS

BGS	Below Ground Surface
BLM	Bureau of Land Management
BLS	Bureau of Labor Statistics
BMP	Best Management Practice
IO	Isolated Occurrence
MSHA	Mining Safety and Health Administration
MSL	Mean Sea Level
NIAS	NMCRIS Investigation Abstract Form
NMCRIS	New Mexico Cultural Resource Information System
NMDOT	New Mexico Department of Transportation
NMED	New Mexico Environment Department
NMOSE	New Mexico Office of the State Engineer
NRCS	Natural Resources Conservation Service (formerly the SCS)
PFYC	Potential Fossil Yield Classification
PoO	Plan of Operations
RC	Reverse Circulation
ROI	Region of Influence
SCS	Soil Conservation Service
SWPPP	Storm Water Pollution Prevention Plan
USDA	United States Department of Agriculture

1.0 APPLICANT INFORMATION [3809.401(b)(1)]

1.1 Operator Information

Operator Name: American Magnesium LLC
Mailing Address: 104 Rinconada
PO Box 684
Elephant Butte, NM 87935-0684
Phone Number: (575) 741-1527
Tax Payer Identification Number: EIN #46-2831543
Point of Contact: David Q. Tognoni, PE
104 Rinconada
PO Box 684
Elephant Butte, NM 87935-0684
Office: (575) 741-1527
Emergency Contact Information: David Q. Tognoni, PE
104 Rinconada
PO Box 684
Elephant Butte, NM 87935-0684
Office: (575) 741-1527

1.2 Claims Information

Owner(s): David Q. Tognoni
Address: PO Box 684
Elephant Butte, NM 87935-0684
Primary Commodity: Magnesium
Claim Name(s): MAG 22 Lode Claim
Claim Type(s): Lode.

1.3 Individual Completing Application

This application is prepared by Amec Foster Wheeler, with input from the Modrall Sperling law firm, on behalf of American Magnesium LLC. All the information contained in the application has been reviewed and verified by American Magnesium LLC.

1.4 Business Information

American Magnesium LLC is a New Mexico limited liability company that was formed on April 30, 2013, for the business of owning mining interests and developing, mining, processing and selling magnesium and other minerals and related substances. Its duration is perpetual.

In May 2013, American Magnesium LLC (AmMg) and American Magnesium LLP were formed in order to facilitate the management of the initial phases of the research and development of the Magnesium Metal Complex. In June 2015, American Magnesium LLP was terminated. In January 2016, American Minerals Management LLC (Manager) was formed to act as manager for AmMg and to continue the research and development of the Magnesium Metal Complex. Manager will provide technical expertise, project management, community and government relations, and financial reporting and accountability to this project. Manager will also facilitate the recruitment of investors for this project.

1.5 Corporation Information

The principal executive offices of American Magnesium LLC are located at 104 Rinconada, Box 684, Elephant Butte, New Mexico 87935. The primary business telephone number is 575-741-1527. Email correspondence should be directed to dqtognoni@gmail.com.

1.6 Partnership Information

American Minerals Management LLC (Manager) was organized in 2016 as a New Mexico limited liability company for the purpose of managing mining development, including additional mineral resource verification, mine planning and other development projects. Its members and principals have experience in minerals resource verification, development, operation and disposition. They are, as of January 31, 2016, as follows:

David Q. Tognoni P.E. – Mr. Tognoni graduated from Arizona State University (ASU) with a Bachelor of Science degree in Geological Engineering and a minor in Industrial Engineering. He completed post-graduate studies in business, finance, and mining engineering at the University of Arizona (Tucson) and ASU. Mr. Tognoni has been a Professional Engineer in good standing for over 35 years. He has worked primarily on special assignment consulting projects for major and junior resource companies in oil, gas, and minerals. Mr. Tognoni was raised around resource/land law, resource verification and resource development. In 2005, Mr. Tognoni founded BE Resources, Inc., an international publicly traded resource company, and served as its and Chief Executive Officer from 2005 to 2012.

Robert Lufkin - Mr. Lufkin attended Arizona State University, College of Construction Engineering, and received certification as a Construction Contract Administrator by the Construction Specifications Institute. This experience has provided him with a full understanding of construction projects from inception to completion. Mr. Lufkin has 40 years of experience in the construction industry. This experience includes project management and field supervision for commercial general contractors and construction contract administration for an international architecture firm. In cooperation with David Tognoni, he has also participated in numerous mineral resource verification projects across the western U.S., recently serving as a board member of BE Resources, Inc., an international beryllium resource verification company. He is also a United States Marine Corps veteran.

This page intentionally left blank

2.0 DESCRIPTION OF OPERATIONS – PROPOSED ACTION [3809.401(b)(2)]

2.1 Legal Description [3809.401(b)(2)(i)]

The Project is located on public lands administered by the BLM, and comprises the southeast quarter of the southeast quarter of section 27, Township 25 South, Range 8 West in Luna County, NM. The project location is depicted in Figure 1.

2.2 Project Access

The Project Area is located within the Tres Hermanas Mining District of Luna County, NM in the western foothills of the Little Florida Mountains, centered on a relatively small hill just west of Mahoney Park. The Project is accessed by traveling on State Road 11 south from Deming for a distance of 12 miles, then turning left on County Road 1286 for a distance of four miles until one encounters a road fork. At the fork one turns right, traveling another 2.4 miles to Mahoney Park (a level area of the valley). Turning right at this point, a four-wheel track continues approximately one mile southwesterly to a location near the base of the dolomite hill. The access routes are shown in Figure 2. Access around the base of the hill is best done using ATV lightweight vehicles.

2.3 Site Ownership (Acres) and Land Status within the Proposed Project Area

The Project Area contains approximately 44 acres of public land administered by the BLM. The target dolomite deposit is encompassed within the boundaries of unpatented mining claims (named Mag 21 & 22 lode mining claims) perfected and maintained under the General Mining Law of 1872, and since AmMg owns those claims, subject only to the paramount title of the United States and surface management requirements of the BLM, it has a real property interest sufficient to conduct development and mining activities thereon, including resource verification, mine development, and mining-related work. The administration authority for the land is shown in Figure 3 and the claim locations are shown in Figure 4.

2.4 Description of Proposed Action and Site Conceptual Design [3809.401(b)(2)(ii)]

The anticipated surface disturbance includes the utilization of overland travel as well as the construction of drill sites, the excavation and removal of dolomite resources, and necessary road improvements. AmMg plans a total of 44 acres of disturbance for mine development, including resource verification, mining, operation, and reclamation activities. The surface disturbance would occur in phases and the final mine plan would be based on the results of the additional resource verification activities which are planned to be conducted as the

initial phase of mining development. Surface disturbance that AmMg plans to conduct under Phase I would occur in the Project Area and is identified on Figure 2. A block cultural survey has been conducted in the Project Area, including all areas planned for mine development, including resource verification drilling, blasting, road construction, drill pad construction, mining, reclamation, and the maintenance and improvement of existing roads.

For the initial phase of mine development, AmMg will use dual-tube, reverse-circulation (RC) air rotary rigs and diamond-bit core rigs at the Project in phases. Each type of drill has its advantages and disadvantages depending upon the nature of the material being drilled, the depth of the target, and the information sought. In most drilling programs, more than one drill rig and often more than one type of drill is used. For some holes, both methods may be used sequentially to complete the resource verification boring. Following are characteristics of each type of drilling method.

- The RC air rig is the standard resource verification drill, used for the drilling range of 100 to 2,000 feet below ground surface, usually to depths of approximately 900 feet below ground surface. At shallow depths, dry air is the working fluid, with water injected optionally for dust suppression. Typical RC drills are truck mounted with optional auxiliary booster compressors to enable deeper penetration.
- Core drilling rigs are used where conditions prevent the use of other rigs and/or where solid samples of rock core are needed for geological, geotechnical, or metallurgical studies. Core rigs may be truck-mounted or skid-mounted and moved on site with a bulldozer.

Existing, primitive roads will require improvement. No new roads are proposed at this time; however, some of the existing roads will be improved with a bulldozer using cut-fill balance methods. The cut-fill balance method results in level surfaces that are essential for movement of the relatively top-heavy, truck-mounted drilling equipment. In areas of relatively low traffic levels with reasonably level terrain, construction of bladed roads would be avoided and drilling equipment would be driven overland to the drill locations. Berms will also be constructed, where necessary, as safety precautions.

Resource verification activities will generally be conducted in two phases. The first phase of drilling is generalized drilling to confirm geologic materials observed at the surface and conceptual geologic models. The first phase of drilling will include approximately 15 acres of disturbance. The second phase of resource verification is to expand on the drilling that produced results. This second phase will include stepping out from the first phase of drilling on spacing between 500 and 1,000 feet, which will result in approximately 29 acres of disturbance. As explained below, the Project includes rolling reclamation such that no more than 40 acres of disturbance will exist at one time. The results of resource verification will be used to phase the mine development. At this time, AmMg plans to mine the resource from the highest elevation to the valley floor, in increments of varying sizes that will avoid more than 40 acres of un-reclaimed disturbance at any one time.

Given the consistent outcropping of dolomite in the Project area, it is possible that the mineralization has little overburden. AmMg's proposed resource verification activities will also verify the amount of overburden present at the site. The proposed method of operation is mining of the ore from the top of the deposit. The AmMg Project will be mined from the top of the dolomite hill down, and the excavated ore will undergo primary crushing, if needed, on site. The Project will be managed to meet the State of New Mexico's requirements for Minimal Impact New Mining Operations (Subpart 3). Reclamation of disturbed areas will be conducted contemporaneously with mining, to the extent feasible, to ensure no more than 40 acres of total un-reclaimed disturbance. During resource verification, each disturbed area will be reclaimed before advancing to the next area. Since verification efforts will result in a minimum of disturbance, the area surrounding the verification drill hole will be regraded and revegetated, using a native seed mix. During operational activities, a detailed Reclamation Plan will be prepared and submitted. This plan will be submitted after the resource verification process is completed.

2.5 Proposed Equipment [38.09.401(b)(2)ii]

One reverse circulation rig and one core drilling rig will be used in the Project Area for mine development. Each rig will include the following support vehicles:

- One pipe truck;
- One booster truck;
- One 3,000-gallon water truck;
- One all-terrain support vehicle; and
- One auxiliary air compressor.

The Project work force during resource verification activities will include one three-man crew per shift for each reverse circulation rig, and one two-man crew per shift for the core rig. One to two geologists will supervise drilling operations. One D7 dozer will be required for rehabilitation of an existing access road and for resource verification road construction. One tracked excavator hoe will be required to aid in existing road rehab, for new road construction, and for drill pad construction. Each field vehicle shall be equipped with hand tools, first aid kit, and a fire extinguisher. Water trucks at the Project Area will be used in the event of a fire. All portable equipment, including drill rigs, support vehicles, and drilling supplies, will be removed from the Project Area during extended periods of non-operation.

During mine operations a comparably-sized work force will be employed to operate the following anticipated equipment, or suitable alternatives, for quarrying the dolomite rock and crushing it for transport off-site:

- Up to 10 haul trucks;
- One 3,000 gallon water truck;

- Two all-terrain support vehicles;
- Storage igloo for blasting storage;
- Excavator;
- Primary crusher, if needed;
- Grader;
- Backhoe; and
- Broadcast seeder for reclamation activities.

Additional details regarding equipment, including the locations where any temporarily stationary equipment will be located, will be provided once mine development and planning is completed. The equipment used will be based on availability and productions rates. AmMg plans to conduct blasting, under an approved blasting plan. This plan will be submitted independently by a licensed and permitted blasting contractor. Once the material is blasted, it will be loaded into over the road haul trucks for transportation off-site. Primary crushing may occur onsite if it is deemed necessary prior to loading the haul trucks. The blast and haul operation that is currently planned is similar in nature to a quarry operation, in that the material will be blasted and excavated from the top of the dolomite hill formation, moving toward the valley floor. At this stage of development, it is assumed that the blasting operation will achieve the required size of material to direct loading to the haul vehicles. No additional on-site crushing is proposed at this time, but that will be evaluated as operations proceed. Based on the production rate, it is possible for quarried material to be temporarily stored on-site prior to transport. The area required for any storage of quarried material will be counted as disturbance for purposes of calculations to ensure the Project does not exceed the 40 acre disturbance footprint already discussed.

2.6 Operating Practices [3809.401(b)(2)ii]

AmMg will follow standard drilling procedures and will require a company representative to be on-site or on-call during all drilling activities. The company representative will monitor and coordinate the layout and construction of each drill site, the setup of the drill rig, drilling progress, demobilization, and cleanup of the drill site. A company geologist will also coordinate drilling activities, log each hole according to the geologic features encountered, determine the maximum depth of each hole, and advise the drill operator as needed. The company representative and geologist will travel to and from the drill site in separate four-wheel drive pickup trucks.

Standard drill rig crews will consist of a drill operator and one or two helpers. The helpers will remove and box the recovered core samples, bag the cuttings from reverse circulation rigs, mix drilling fluids in the portable mud tank, operate the water truck, assist with drilling operations, and conduct maintenance as necessary. The crew will be transported to and from the drill site in four-wheel drive vehicles.

The mine will operate similar to a quarry operation. However, no crushing, screens or conveyers are currently planned for use. The dolomite will be blasted, in accordance with an approved blasting plan (to be submitted at a later date) and loaded into haul trucks for off-site transportation. Blasting and hauling operations are planned to be conducted during daylight hours. The proposed mining activities are currently planned to operate during daylight hours. No nighttime operations or 24-hour operations are planned at this time.

2.7 Mining Operations and Ancillary Facilities

No construction of permanent structures for mining operations or ancillary facilities will be required. Even if primary crushing onsite is needed, the crushing facility will be demobilized and removed at the end of the mining operations. The mining operation does not require support structures to be constructed. AmMg will have a mobile office trailer and portable out-house and sanitation facilities for workers on the site, all of which will be removed following mining. A laydown area for mining equipment will be developed within the footprint of the mining operations. The laydown and equipment staging area will be included within AmMg's disturbance calculations. Storage for explosives in temporary storage building (two buildings approximately 8 X 8) and one explosive silo are also planned for the storage of explosives expected to be used during mining operations to blast the rock for excavation and transport. There will be no processing or other ancillary facilities required for resource verification activities or mining operations.

2.8 Site Access and Proposed Constructed Roads

The Project consists of expanding and maintaining certain existing dirt roadways in order to access the proposed mining site and to transport extracted ore to a manufacturing facility that is currently planned to be located the Peru Industrial Park in Deming, NM. Two routes to the mine site are being considered, referred to as the North Route and the South Route. The North Route is 5.0 miles long, 4.1 miles of which is on BLM land. The South Route is 4.6 miles long, 3.0 miles of which is on BLM land. Based on available information regarding the resource, the estimated duration of mining operations is 30 years. The roads would be used year-round. The road improvements would occur during daylight hours, and would be completed as quickly as possible.

Existing roads on the property are planned to be improved by blading or otherwise resurfacing existing road surfaces and, in some limited areas, by widening the existing roads. The total estimated disturbance beyond existing road widths from widening is 1 acre for all roads that will be improved. The existing roads will be improved to allow for movement of heavy equipment and the average running width of 14 to 16 feet for roads within the property boundary proposed. Road improvements will occur in areas with varying topography, and as a result, roads will have an average disturbance width of 25 feet. Planned disturbance associated with road improvement is shown in Table 1. Resource

verification roads that require earth-moving will be constructed using typical construction practices to minimize surface disturbance, erosion, and visual contrast, as well as to facilitate reclamation. A modest amount of overland travel is planned to access certain drill pad locations and to conduct blasting operations. Overland travel will be limited and will only be conducted when needed, and areas affected thereby will be counted as part of the disturbance footprint.

Road improvements will be implemented using a Caterpillar dozer, backhoe, or equivalent equipment. Road grades will be no steeper than ten percent, except for short drill spurs, in order to be consistent with the BLM roads manual. When drainages must be crossed by a road, Best Management Practices (BMPs) established by MMD and the Luna County Soil Conservation District will be followed in order to minimize the surface disturbance and erosion potential. Culverts may be required in various areas along the proposed access road. These areas will be reviewed with BLM, and culverts will be installed as required by BLM. It is not anticipated that blasting will be necessary to construct roadbeds. If drilling and blasting of roads should become necessary, prior to blasting the operator will submit a blasting plan to the MMD.

Routine road maintenance may be required and will consist of smoothing ruts, filling holes with fill material, grading, and re-establishing waterbars when necessary. In addition, AmMg may need to blade and emplace gravel surfacing on the roads to minimize excess disturbance. The gravel will be obtained from outside the Project Area from a commercial gravel source.

Balanced cut and fill construction will be used to the extent practicable to minimize the exposed cut slopes and the volume of fill material. Since the depth of the cut will be kept to a minimum, growth media removed during construction will be stockpiled as the fill slope to be used during reclamation. Road construction within drainages will be avoided where possible. When drainages must be crossed by a road, BMPs established by MMD and the Luna County Soil Conservation District will be followed to minimize the surface disturbance and erosion potential.

Approximately 5,000 feet of the existing access road will require rehabilitation to safely accommodate resource verification and future ore hauling traffic. These areas requiring rehabilitation are shown on Figure 2. Considering an average disturbance width of ten feet outside of the existing road prism in the proposed rehabilitation areas, it is estimated that 1.0 acre of disturbance will be required to improve these areas of the existing access road.

2.9 Use and Occupancy

Under 43 CFR 3715.01, occupancy means full or part-time residence on the public lands. It also means activities that involve residence; the construction, presence, or maintenance of temporary or permanent structures that may be used for such purposes; or the use of a watchman or caretaker for the purpose of monitoring activities. Residence structures

include, but are not limited to, barriers to access, fences, tents, motor homes, trailers, cabins, houses, buildings, and storage of equipment or supplies.

No structures, except for the possibility of a temporary crushing facility as listed above, are proposed in this Plan to be located on public lands; however, AmMg may utilize a trailer in the Project Area for logging core and cuttings. A temporary, 5,000-gallon water tank will also be located in the Project Area for resource verification and mining operations to aide in dust suppression activities during periods of mining and for general road maintenance. Additionally, porta-potties are planned to be utilized in the Project Area.

2.9.1 Proposed Temporary and Permanent Structures

Intermodal containers may be used to store project equipment and supplies at the site. A temporary job trailer is also proposed for employees to gather for health and safety briefings, store personnel belongings during working hours, shelter during inclement weather and serve a meeting and break facility during resource verification and mining.

2.9.2 Access Restrictions to Mining Site

If necessary, AmMg would construct BLM-approved barbed wire fencing to prevent livestock from entering disturbed areas. In areas where a higher level of security or safety is needed, for example in the mobile trailer area and laydown yard, chain-link fences would be erected. Gates or cattle guards would be installed along roadways within the proposed mine area, as appropriate.

AmMg shall monitor any constructed fences on a regular basis and repairs would be made as needed. In the event that livestock manage to enter the proposed area of disturbance via a gate or opening in a fence, the grazing permittee would be contacted immediately. AmMg would assist as requested in moving these animals out of the proposed mine area.

The use of avian exclusion devices to prevent deleterious exposure of birds will not be required, as no toxic or hazardous chemical are planned to be used. In addition, no ponds will be constructed. The only water needed would be for dust suppression, and a water truck and on-site storage tank (enclosed) will be used to apply water to the surface to prevent dust.

2.9.3 Estimated Duration for Use of On-site Structures

Temporary structures may be used throughout the duration of resource verification, mine development and mining activities.

2.10 Hazardous Materials (Hazmat)

Hazardous materials utilized at the Project Area will include diesel fuel, gasoline, and lubricating grease. Approximately 500 gallons of diesel fuel will be stored in fuel delivery systems on vehicles and drill rigs. Approximately 100 gallons of gasoline will be stored in fuel delivery systems for light vehicles. Approximately 100 pounds of lubricating grease will be stored on the drill rigs or transported by drill trucks. All containers of hazardous substances will be labeled and handled in accordance with requirements of the New Mexico Department of Transportation (NMDOT) and Mining Safety and Health Administration (MSHA). In the event that a reportable quantity of hazardous or regulated materials, such as diesel fuel, is spilled, immediate measures will be taken to control and address the spill, and the New Mexico Environment Department (NMED), and the Emergency Response Hotline will be notified, as may be required. If any oil, hazardous material, or chemicals are spilled during operations, they will be cleaned up in a timely manner. After clean up, the oil, toxic fluids, or chemicals and any contaminated material will be removed from the site and disposed of at an approved disposal facility.

Blasting components, including ammonium nitrate and diesel fuel, would be stored on-site in bins and tanks during mining operations. AmMg currently anticipates utilizing two explosives magazines (one for boosters and one for blasting caps), each no larger than 8 feet by 8 feet, with 1,000-pound capacities. In addition, AmMg would utilize one 15-ton capacity silo for storage of ammonium nitrate. All explosive materials would be stored in compliance with MSHA, New Mexico SMIO's regulations, and U.S. Department of Homeland Security requirements. Management of hazardous materials would comply with all applicable Federal, State, and local requirements, including the inventory and reporting requirements of Title III of CERCLA, also known as the Emergency Planning and Community Right to Know Act. All petroleum products, kerosene, and reagents used would be stored in aboveground tanks within a secondary containment area capable of holding 110 percent of the volume of the largest vessel in the area.

2.11 Spill Prevention Plan [3809.401(b)(2)(vi)]

Over the life of the proposed Project, small or limited spills of oils and lubricants may occur during fueling or from equipment. These releases could occur during operations, for example, as a result of a bad connection on an oil supply line, from equipment failure, or from mishandling during transfer operations. Equipment will be inspected and properly maintained to limit adverse impacts from any unintentional release. Impacts of such minor spills could include contamination of surface soils. Spills of this nature would most likely be small, localized, and contained. Formal safety data sheets for hazardous materials would be posted and readily available, in accordance with MSHA's Hazard Communication for the Mining Industry (30 CFR Part 47).

The potential for spills of both hazardous and non-hazardous materials would be further mitigated with the implementation of a spill prevention plan. The Spill Prevention Plan for the Project describes the reporting requirements and response actions that would take place in the event of a spill, release, or other unexpected condition, as well as procedures for cleanup and disposal. The plan will be posted and distributed to key site personnel and will be used as a guide in the training of employees. The plan addresses mitigation of potential spills associated with project facilities as well as activities of on-site contractors. The plan will be reviewed and updated at a minimum of every 3 years, and whenever major changes are made in the management of the materials addressed in the plan. Inspection and maintenance schedules and procedures for equipment at the site will be set forth in sections of the plan addressing hazardous materials and petroleum products. In addition, the implementation of a health and safety manual and hazard communication program will provide employees with education and awareness of hazardous materials management, thereby further minimizing the potential for spills at the mine area. A Spill Prevention Plan for the Project will be included as Appendix A. This plan will be submitted at a later date.

2.12 Project-specific Quality Assurance Plan [3809.401(b)(2)(v)]

A quality assurance plan is not applicable as this is a mine development and quarry project. However, quality assurance for reclamation will be addressed under the Reclamation Plan (Section 3).

2.13 Water Use and Management [3809.401(b)(2)(iii)]

Minimal or no water will be required for the mining process. Water for sanitation and dust suppression purposes will be brought to the site using a 5,000 gallon water truck, portable water tank, or similar vessel. If water is needed to resource verification activities, a water truck, portable water tank, or similar vessel will also be used. Resource verification holes are limited in depth and minimal water will be used. Water will be used for dust suppression and site reclamation activities.

2.14 Environmental Protection Measures

AmMg commits to compliance with all applicable environmental protection measures, including but not limited to the following, to prevent unnecessary or undue degradation during construction, operation, and reclamation of the Project. The measures are derived from the general requirements established in the BLM's Surface Management Regulations at 43 CFR 3809 and water, air quality, and other environmental protection regulations, including the reclamation requirements applicable to minimal impact new mining operations under the Mining Act Reclamation Program rules administered by MMD.

2.14.1 Water Quality

- Drill holes will be surveyed and plugged as an operational procedure immediately after completion of drilling in accordance with 19.10.4 NMAC. The drill holes will be plugged by placing drill cuttings or cement grout, concrete grout, or neat cement plug into the total depth of the hole, or if ground water is encountered, plugged as a well pursuant to 19.27.4 NMAC. There is a limited chance that groundwater will be encountered during drilling, given the proposed depth of the drill holes.
- Storm water BMPs will be used at construction sites to minimize erosion from storm water.
- Drill cuttings will be contained on-site and the fluids will be managed utilizing appropriate control measures. Sediment traps will be used as necessary and filled at the end of the drill program.
- The Spill Prevention Plan, Appendix A, will be followed.
- Only nontoxic fluids will be used in the drilling process.

2.14.2 Air Quality

- Emissions of fugitive dust from disturbed surfaces will be minimized by the application of water from a water truck as a method of dust control.
- In addition, gravel may be emplaced on some existing roads to minimize excess disturbance and control dust. A Storm Water Pollution Prevention Plan (SWPPP) will be required because the proposed surface disturbance exceeds one acre. A Sediment Control Plan will be included in the SWPPP, which will be provided at a later date.

2.15 Site Geology

The proposed site for the Project, sometimes referred to as the Foothills Dolomite Quarry, encompasses a foothill that rises 200-300 feet above the western alluvial fans of the Florida Mountains, west of Mahoney Park. Rock formations that entirely make up the site are the Fusselman and the Montoya Formations. These strata are Ordovician and early Silurian in age, and are part of a regionally extensive carbonate platform that stretches into Texas and Oklahoma. The platform was part of a shallow sea that once formed the southwest continental margin of Laurentia. Broad exposures of these rocks occur wherever there is significant mountain block faulting of Paleozoic rocks in southern New Mexico and West Texas, including the San Andres, Sacramento and Franklin mountain ranges. On the western flank of the Florida Mountains, these rocks are highly faulted and brecciated by high angle Laramide thrust faulting and tilted to the east and southeast, complicating their stratigraphy.

The Fusselman and Montoya formations contain primarily dolomitized limestones and dolomitic sandstones. Fossils in these formations are primarily shallow marine invertebrates such as corals and crinoids. Dolomitization has destroyed much of the internal structure of the fossils that are not replaced by silica, due to recrystallization. Results of the literature based paleontological resource survey are summarized in Section 2.15.4 of this Plan of Operations.

2.15.1 Hydrology

The proposed Foothills Dolomite Quarry lies in the south-central portion of the Mimbres basin, a closed basin bounded by mountain ranges on all sides, extending from the Continental Divide to the Black Range and Silver City to the north and south, into the Chihuahua province of Mexico. The primary aquifer in the region is made up of basin fill. Mountain-front recharge and the Mimbres River provide the majority of recharge to the aquifer. Modeled potentiometric surfaces near the western flank of the Florida Mountains are approximately 4500 feet above mean sea level (MSL) or about 300 feet below ground surface (BGS) at the base of the quarry site foothill.

Surface water in the immediate area of the proposed quarry flows via ephemeral stream channels westward, down the slope of the Florida Mountains alluvial fan to a relatively flat intermontane basin with no large bodies of surface water.

The only perennial stream or large body of surface water in the Mimbres Basin is the Mimbres River, which flows south from the Black Range and then turns east just north of Deming, NM. The river terminates in a closed basin a few miles east of Deming, NM with no large bodies of surface water.

2.15.2 Soils

The rocky prominence that is the primary interest at the site is entirely composed of bedrock, virtually devoid of soil exposures, and is mapped by the US Department of Agriculture National Resource Conservation Service as *Rough and Broken Rock Land*. The alluvial fan from which it rises is mapped as the *Eba Very Gravelly Clay Loam*. This latter soil unit appears on alluvial fans and fan remnants with slopes of zero- to ten percent. Runoff potential is moderately high when wet, due in part to its clayey matrix. The typical soil profile of this unit is as follows:

- 0-2 inches: Very gravelly clay loam
- 2-60 inches: Very gravelly clay

A custom soils report detailing the properties of the Eba Very Gravelly Clay Loam, generated by the U.S. Department of Agriculture Natural Resources Conservation Service (NRCS) from information originally presented in the Soil Survey of Luna County, NM, is presented in Appendix B.

2.15.3 Vegetation

The plant community in the project area and vicinity is a matrix of Chihuahuan Desert Broadleaf Evergreen Scrub and Chihuahuan Desert Broadleaf Deciduous Desert Scrub (BISON-M 2016). Shrubby species dominate the vegetation of the Project area and include honey mesquite (*Prosopis glandulosa*), broom snakeweed (*Gutierrezia sarothrae*), ocotillo (*Fouquieria splendens*), sotol (*Dasylirion wheeleri*), redberry juniper (*Juniperus arizonica*), and yellow trumpetbush (*Tecoma stans*). Cactus species and other succulents such as candy barrelcactus (*Ferocactus wislizeni*), cholla (*Cylindropuntia sp.*), prickly pear cactus (*Opuntia sp.*), Graham's nipple cactus (*Mammillaria grahamii*), and Palmer's century plant (*Agave palmeri*) are also common. Grasses and forbs are less common in the rocky, shrubby terrain, including threeawn (*Aristida sp.*), matted grama (*Bouteloua simplex*), and silverleaf nightshade (*Solanum elaeagnifolium*). Table 1 contains a list of all plant species identified in the project area during the biological field survey on July 28, 2016. Copies of the field survey, conducted by EnviroSystems Management, Inc. (EnviroSystems), is provided in Appendix C with the Cultural Resources Report.

Table 3. Complete List of Plant Species Observed in the Project Area.

Common Name	Scientific Name
Trees	
redberry juniper	<i>Juniperus arizonica</i>
singleneedle pinyon	<i>Pinus monophylla</i>
honey mesquite	<i>Prosopis glandulosa</i>
Shrubs/Sub-shrubs	
saltbush	<i>Atriplex sp.</i>
broom snakeweed	<i>Gutierrezia sarothrae</i>
yellow trumpetbush	<i>Tecoma stans</i>
Forbs	
Cochise scaly cloakfern	<i>Astrolepis cochisensis</i>
silverleaf nightshade	<i>Solanum elaeagnifolium</i>
Cacti, Agave, & Succulents	
Palmer's century plant	<i>Agave palmeri</i>
cholla	<i>Cylindropuntia sp.</i>
sotol	<i>Dasylirion wheeleri</i>
candy barrelcactus	<i>Ferocactus wislizeni</i>
ocotillo	<i>Fouquieria splendens</i>
Graham's nipple cactus	<i>Mammillaria grahamii</i>
prickly pear cactus	<i>Opuntia sp.</i>
soaptree yucca	<i>Yucca elata</i>

Common Name	Scientific Name
Grasses	
threeawn	<i>Aristida sp.</i>
matted grama	<i>Bouteloua simplex</i>

2.15.3.1 Noxious Weeds

Noxious weeds will be controlled through implementation of the following BMPs: concurrent reclamation efforts to the extent feasible; operator control; removal of invasive, nonnative, and noxious weeds on reclaimed areas; washing heavy equipment prior to entering the Project Area; and avoiding areas of known invasive, nonnative, and noxious weeds during periods when the weeds could be spread by vehicles.

2.15.4 Cultural and Paleontological Resources

Dos Rios Consultants, Inc. performed a Class III archaeological survey of the proposed quarry site from August 5 through August 8, 2016 (Report provided in Appendix C). Seventeen isolated occurrences (IOs) were found within the survey area. An isolated occurrence (IO) is a single or scatter of artifacts or a feature (or features) that are not extensive enough to meet the criteria of being an archaeological site. The IOs within the survey area ranged from isolated mine shafts to fragments of ceramics, metal cans and fragments of rock from the working of stone tools. No archaeological sites were discovered during the survey. A copy of the New Mexico Cultural Resource Information System (NMCRIS) Information Abstract Form (NIAF), a summary of the archaeological survey finds, is presented in Appendix C. Table 4 below lists the IOs.

Table 4: Isolated Occurrences Found During the Inventory has been removed from this report as confidential information.

Amec Foster Wheeler has extensively reviewed geologic literature pertaining to fossil fauna in the locality and stratigraphic intervals present at the proposed quarry site, and proposes that the site should be given a classification of Class 2, i.e., *Low*, under the BLM Potential Fossil Yield Classification (PFYC) System.

A PFYC rating of Class 2 means that the gross potential fossil yield for the rock units present is low, and refers to sedimentary geologic units that are not likely to contain vertebrate fossils or scientifically significant non-vertebrate fossils. Scientifically significant fossils are generally defined as: *all vertebrate fossils and their tracks or traces, and some invertebrate or plant fossils identified as rare or important by the scientific community*. Typical geological and paleontological conditions for a Class 2 classification include:

- Vertebrate or significant invertebrate or plant fossils not present or very rare.
- Units that are generally younger than 10,000 years before present.
- Recent aeolian deposits.
- Sediments that exhibit significant physical and chemical changes (i.e., diagenetic alteration).

The fossils found in the Fusselman and Montoya Formations are primarily shallow marine invertebrates, e.g., horn corals, echinoderms, brachiopods and gastropods. Both formations have undergone significant chemical diagenesis from dolomitization, which destroys structural detail in carbonate fossils through recrystallization. Some of the corals in the Fusselman are preserved by silica replacement. However, the carbonate platform in which the formations present at the site formed is very extensive; and both the Fusselman and Montoya Formations have many outcrops across the southern portion of the State of New Mexico and Texas.

- Pursuant to 43 CFR 10.4(g), AmMg will notify the BLM authorized officer, by telephone, and with written confirmation, immediately upon the discovery of human remains, funerary objects, sacred objects, or objects of cultural patrimony (as defined in 43 CFR 10.2). Further, pursuant to 43 CFR 10.4 (c) and (d), the operator will immediately stop all activities in the vicinity of the discovery and not commence again for 30 days or when notified to proceed by the BLM authorized officer.
- In the event that previously undiscovered paleontological resources are discovered in the performance of any surface disturbing activities, the item(s) or condition(s) will be left intact and immediately brought to the attention of the authorized officer of the BLM. If significant paleontological resources are found, avoidance, recordation, and data recovery will be required.
- Any cultural resource discovered by the permit holder, or by any person working on their behalf, during the course of activities on federal land will be immediately

reported to the authorized officer by telephone, with written confirmation. The permit holder will suspend all operations in the immediate area of such discovery and protect it until an evaluation of the discovery can be made by the authorized officer. This evaluation will determine the significance of the discovery and what mitigation measures are necessary to allow activities to proceed. The holder is responsible for the cost of evaluation and mitigation. Operations may resume only upon written authorization to proceed from the authorized officer.

2.15.5 Wildlife

The project area provides habitat for a variety of mammals, reptiles, and birds. Wildlife species encountered during the biological survey included a whiptail lizard (*Aspidoscelis* sp.) and various species of birds, including cactus wren (*Campylorhynchus brunneicapillus*), Gambel's quail (*Callipepla gambelii*), northern mockingbird (*Mimus polyglottos*), black-chinned sparrow (*Spizella atrogularis*), bushtit (*Psaltiriparus minimus*), thrasher (*Toxostoma* sp.), and greater roadrunner (*Geococcyx californianus*). See Table 5 for a list of all wildlife species identified during the biological field survey.

Table 5. Complete List of Wildlife Species Observed in the Project Area.

Common Name	Scientific Name
Birds	
black-chinned sparrow	<i>Spizella atrogularis</i>
bushtit	<i>Psaltiriparus minimus</i>
cactus wren	<i>Campylorhynchus brunneicapillus</i>
Gambel's quail	<i>Callipepla gambelii</i>
greater roadrunner	<i>Geococcyx californianus</i>
northern mockingbird	<i>Mimus polyglottos</i>
thrasher	<i>Toxostoma</i> sp.
Reptiles	
whiptail lizard	<i>Aspidoscelis</i> sp.

2.15.6 Migratory Birds

To avoid potential impacts to and unintentional takes of migratory bird species, it is recommended that significant quarrying activities be initiated outside of the breeding season (March 1 to August 31). If activities were to occur during this time period, a survey for nesting birds would be completed to ensure there are none on-site. It is expected that the ongoing disturbance caused by these activities will then deter migratory birds from nesting in the project area in the future.

2.15.7 Public Safety and Site Access

- Public safety will be maintained throughout the duration of the Project. All equipment and other facilities will be maintained in a safe and orderly manner.
- Any survey monuments, witness corners, or reference monuments will be protected to the extent economically and technically feasible.
- All solid wastes will be disposed of in a state, federal, or local designated site.
- Pursuant to 43 CFR 8365.1-1(b)(3), no sewage, petroleum products, or refuse will be dumped from any trailer or vehicle.
- All applicable state and federal fire laws and regulations will be observed and all reasonable measures will be taken to prevent and suppress fires in the Project Area.

2.15.8 Socioeconomic Conditions in and Around the Proposed Project Area

The analysis of socioeconomic resources identifies aspects of the social and economic environment that are sensitive to changes and that may be affected by the proposal to conduct resource verification activities, mining development, and mining operations. The analysis specifically considers how the proposed actions might affect the individuals, communities, and the larger social and economic systems of Luna County, the surrounding region; and the State of New Mexico.

Appendix D of Social Science Considerations in Land Use Planning Decisions of BLM's Land Use Planning Handbook H-1601-1 provides guidance on how social and economic issues and concerns may be incorporated into the planning process. This section evaluates socioeconomic characteristics, including population, employment, housing, community services, and economic systems. Social impacts would be felt most by individuals, communities, residents, and workers in Luna County. Businesses, community services, and economic systems in Luna County would likely change the most in response to the implementation of the Proposed Action. Since potential impacts with the greatest magnitude, duration, extent, and likelihood would occur in Luna County, it is therefore defined as the Region of Influence (ROI) for the analysis of socioeconomic impacts. Impacts that extend outside of the ROI are discussed where applicable throughout the section.

The data supporting this analysis are collected from standard sources, including the U.S. Census Bureau (Census), Bureau of Labor Statistics (BLS), other Federal, State, and local agencies, or other research institutes. Demographic and economic data is presented for Luna County and compared to demographic and economic data for the State of New Mexico. Demographic data from the Census is also presented for the City of Deming as applicable. The inclusion of demographic data for the City of Deming does not change the ROI, since these are located within Luna County.

2.15.8.1 Population

The 2010 estimated population of Deming is 14,855, a net increase of 739 or 5 percent from the 2000 estimated population. The State population grew by 13.2 percent from 2000-2010. Luna County grew negatively by 0.1 percent and 11.2, respectively.

Table 6. Population Change, 2000-2010

Location	2000	2010	Numeric Change 2000-2010	Percent Change 2000-2010
Deming	14,116	14,855	739	5
Luna County	25,016	25,095	79	>0.01
New Mexico	1,819,046	2,059,179	240,133	13.2

Source: U.S. Census Bureau 2000, 2010.

In general, the population of Luna County is older than that of the state as a whole. The percentage of children in Luna County (the ROI), including those under 5 years and between 5 and 18 years, is lower than percentages for those same age groups in the State of New Mexico. Population estimates and the percent of children by age group in the City of Deming, Sierra County, and New Mexico are shown below.

Table 7. Population Under 18 Years of Age, 2010

Location	Total population	Children Under 5 Years	Children 5 to 18 Years	All Children Under 18 Years
Deming	14,855	8%	19.6%	27.6%
Luna County	25,095	7.3%	19.2%	26.5%
New Mexico	2,059,179	7%	18.1%	25.1%

Source: U.S. Census Bureau 2010

The distribution of population by age in Luna County, including the City of Deming, and New Mexico is summarized below. The percent of the population between the ages of 20 and 44 is lower in Luna County than in the State as a whole. The percent of persons 65 and older in Luna County is about double the percent in the State overall.

Table 8. Distribution of Population by Age, 2010

Location	Percent Under 18 Years	Percent 20-44 Years	Percent 45-64 Years	Percent 65 and Older
Deming	27.6	28.9	21.8	21.7
Luna County	26.5	26.8	24.4	22.3
New Mexico	25.1	64.8	26.5	13.2

Source: U.S. Census Bureau 2010

2.15.8.2 Housing

A housing unit refers to a house, an apartment, a mobile home or trailer, a group of rooms, or a single room occupied as separate living quarters, or if vacant, intended for occupancy as separate living quarters. An owner-occupied housing unit indicates that the owner or co-owner lives in the unit even if mortgaged or not fully paid for. The median value(s) of housing units reflects housing units with and without a mortgage. A household includes all the people who occupy a housing unit as their usual place of residence.

Luna County has 10,999 total housing units. About 67.4 percent of homeowners in Luna County occupy their housing unit. The median value of housing in New Mexico is 48 percent higher than in Luna County.

2.16 Proposed Preliminary Schedule of Operations (Concept to Closure)

The verification of the resource is expected to take approximately 1 year. During this time, the workforce would average about 5 to 10 persons per day. The estimated operational life required to recover the minerals 30 years, although this estimate likely will be refined using the results of the resource verification. The mining activities, which will be similar to quarrying, will be conducted and are anticipated to take up to 30 years and employ up to 10 on-site personnel. The reclamation workforce would consist of up to 10 employees. Reclamation will occur contemporaneously during operations, to the extent feasible, and will be conducted in the form of “rolling” reclamation to support phased approach within a maximum 40 acre disturbance footprint, and after all mining/quarrying activities are completed.

Southwestern New Mexico and Luna County have a history of mining and agriculture, and AmMg would provide employment opportunities to individuals living in the immediate area of the project. It is likely that personnel from outside the local area would be required in order to meet the full needs of the Project; however, the southwestern United States is capable of providing a large base of experienced personnel.

2.17 Other Plans and Requirements

The following Plans and Requirements are anticipated for this project:

- SWPPP (to be provided)
- Blasting Plan (to be provided)
- MMD Minimal Impact New Mining Permitting (submitted to MMD)

This page intentionally left blank

3.0 RECLAMATION PLAN [3809.41(b)(3)]

Disturbed areas that are not needed for, or within the planned footprint of, ongoing operations shall be reclaimed. These areas include the office area and laydown yard. They also include the final surface once the deposit is quarried to the valley floor. Areas will be restored to a safe and stable condition that blends with the surrounding undisturbed area, and that meets MMD's requirement to achieve a self-sustaining ecosystem appropriate for the surrounding area that is consistent with approved post-mining land uses. The impacted surface area shall substantially be restored to the condition that existed prior to operations by placement of a soil cover, re-contoured so that the remaining ground surface approximates the surrounding topography and will be re-vegetated. Disturbed areas shall be maintained to control dust and minimize erosion to the extent practicable.

Topsoils and subsoils shall be replaced more or less to their original relative positions and contoured so as to achieve erosion control, long-term stability and preservation of surface water flow patterns. The disturbed area then shall be reseeded in the first favorable growing season following closure of the Project.

If it is determined that the areas disturbed are reasonably needed for future production operations, but will not be utilized reasonably promptly, the disturbed areas will be compacted, covered, or otherwise stabilized and maintained in such a way as to minimize dust and erosion to the extent practicable but in anticipation of use in future operations.

If the areas will no longer be used for mining operations, reclamation will begin as soon as reasonably practicable. Reclamation of all disturbed areas no longer in use shall be considered complete when all ground surface disturbing activities at the site have been completed, and a uniform vegetative cover has been established that reflects a life-form ratio of plus or minus fifty percent (50%) of pre-disturbance levels and a total percent plant cover of at least seventy percent (70%) of pre-disturbance levels, excluding noxious weeds. Seeding will be conducted as outlined in New Mexico State University Cooperative Extension Service Circular 525. Notification shall be provided when reclamation and re-vegetation are complete.

3.1 Mine Reclamation [3809.401(b)(3)(ii)]

Reclamation will be completed to the standards described in 43 CFR 3809.420(3) and New Mexico Mining and Minerals Part 3 requirements. Reclamation will meet the reclamation objectives as outlined in the U.S. Department of Interior Solid Minerals Reclamation Handbook #H-3042-1 (BLM 1992), Surface Management of Mining Operations Handbook H-3809-1 (BLM 1989), and revegetation success standards per BLM/NDEP "Revised Guidelines for Successful Mining and Resource verification Revegetation" (BLM 1999). All drill sites, sumps, and road construction will be re-contoured and reseeded.

Reclamation will be designed to achieve land uses consistent with the BLM- and New Mexico Mining and Minerals-approved Post Mine Land Uses (PMLUs) and any applicable land use management plans for the area. Reclamation is intended to return disturbed land to a level of productivity comparable to pre-resource verification levels. Land use includes wildlife habitat, livestock grazing, hunting, and dispersed recreation. The post-mining land uses are not expected to differ from pre-project land use.

During Project activities, reclamation will involve management of drilling to contain cuttings and manage drilling fluids, monitoring road conditions, and keeping sites clean and safe. During seasonal closure of the Project and periods of inactivity between drilling phases, reclamation will involve cleaning sites, and maintaining the overall safety of the Project Area. The BLM and MMD will be notified prior to any periods of inactivity greater than 120 days.

After Project activities are completed, reclamation will involve regrading disturbed areas related to this Project to their approximate adjacent contours. The Project will then be seeded using the approved reclamation seed mixture and application rates furnished by the BLM. Yearly visits to the site will be conducted to monitor the success of the revegetation for a period of up to three years or until revegetation success has been achieved.

3.2 Regrading and Reshaping of 40-Acre Disturbed Area [3809.401(b)(3)(ii)]

Upon closure of the operations, disturbance locations will be reclaimed according to the reclamation plan. Prior to final closure, AmMg will confer with the State of New Mexico and the BLM will determine which roads used or improved during operations should be left intact around the site in order to conduct post-closure monitoring or provide adjacent landowner access. All other mine-related roads that were not in existence at the commencement of operations contemplated by this PoO would be reclaimed.

3.3 Revegetation [3809.401(b)(3)(vii)]

Where salvageable soil exists in areas that are to be newly disturbed, AmMg will salvage as much material as can be safely and practically recovered. The lack of reclamation cover material available from disturbed areas and the poor development of topsoil (top dressing) at the site may require the evaluation of alternative sources and types of materials for use as reclamation cover and suitable growing media.

Where possible, the near-surface alluvial materials from within the limits of ground-disturbing operations will be salvaged to cover the identified soil deficit to meet reclamation cover requirements. Diversion ditches will be constructed and maintained around the reclamation material stockpiles to prevent run-on erosion. Salvage material stockpiles will be seeded with an interim, weed-free seed mix. Seeding is typically done once, right before the monsoon season. Prior to and during soil salvage, woody plants and

vegetation will be removed. Except to the extent any plants may be recovered and salvaged or transplanted by AmMg or others who may be permitted to do so, the vegetation will be combined with the growth media to increase the organic matter content of the growth media.

3.4 Wildlife Rehabilitation [3809.401(b)(3)(v)]

Reclamation of the Project area will be conducted to achieve a stable configuration and a self-sustaining ecosystem appropriate for the life zones of the surrounding area, and access to the site will be restricted for protection of the public and animals. The Project will result in the reclamation of land disturbed by quarrying activities.

3.5 Removal of Building and Associated Structures [3809.401(b)(3)(ix)]

All temporary structures required for the Project will be demobilized or demolished and removed from the site for appropriate disposition when activities are completed.

3.6 Post-Closure Management [3809.401(b)(3)(x)]

Following the completion of reclamation and closure activities, revegetation will be monitored for at least two growing seasons and will meet Part 3 requirements under the New Mexico Mining Act. In accordance with Paragraph (2) of Subsection S of 19.10.1 NMAC, a “self-sustaining ecosystem” will be established for all reclaimed areas impacted by mine development. The reclaimed land will be self-renewing without augmented seeding, amendments, or other assistance which is capable of supporting communities of living organisms and their environment. By MMD definition, a “self-sustaining ecosystem” includes hydrologic and nutrient cycles functioning at level of productivity sufficient to support biological diversity. No discharges that will impact groundwater are anticipated from the proposed activities; only water for dust suppression is planned.

3.7 Project Maps

The project location, access routes, surface land administration, and claim locations are presented below.

Figure 1. Project Location

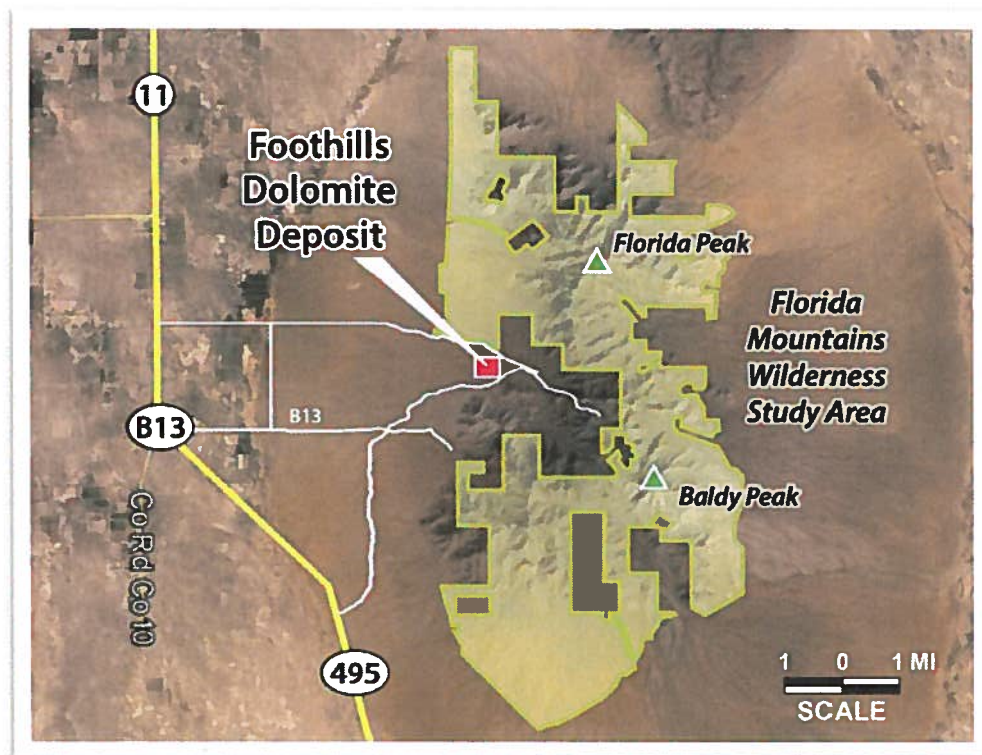
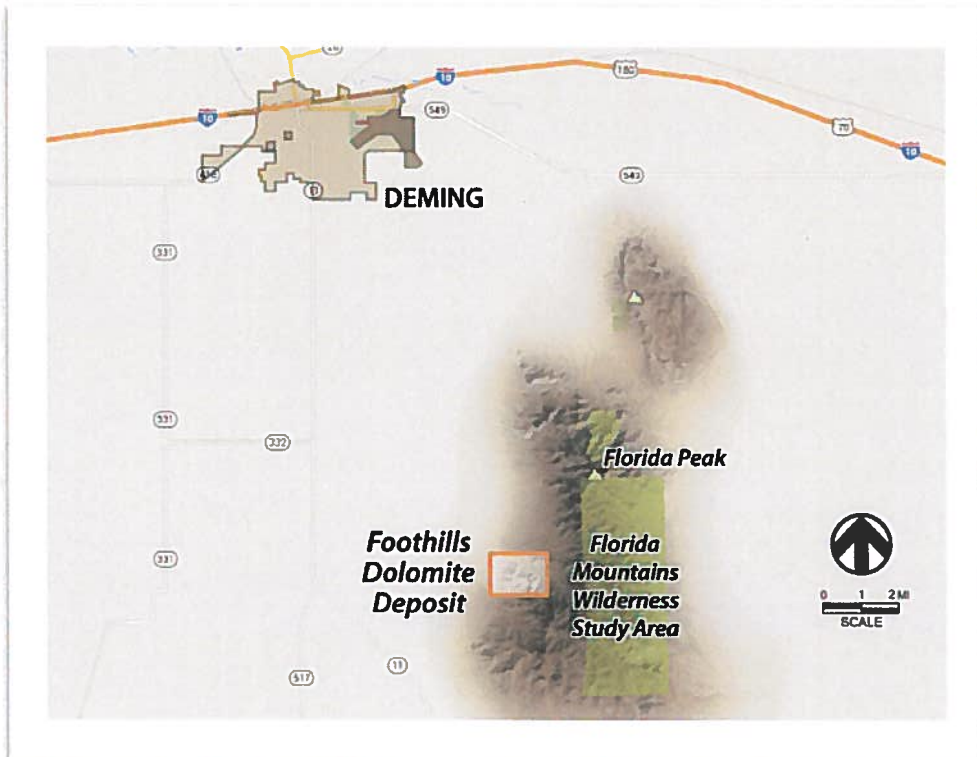

Figure 2. Site Access

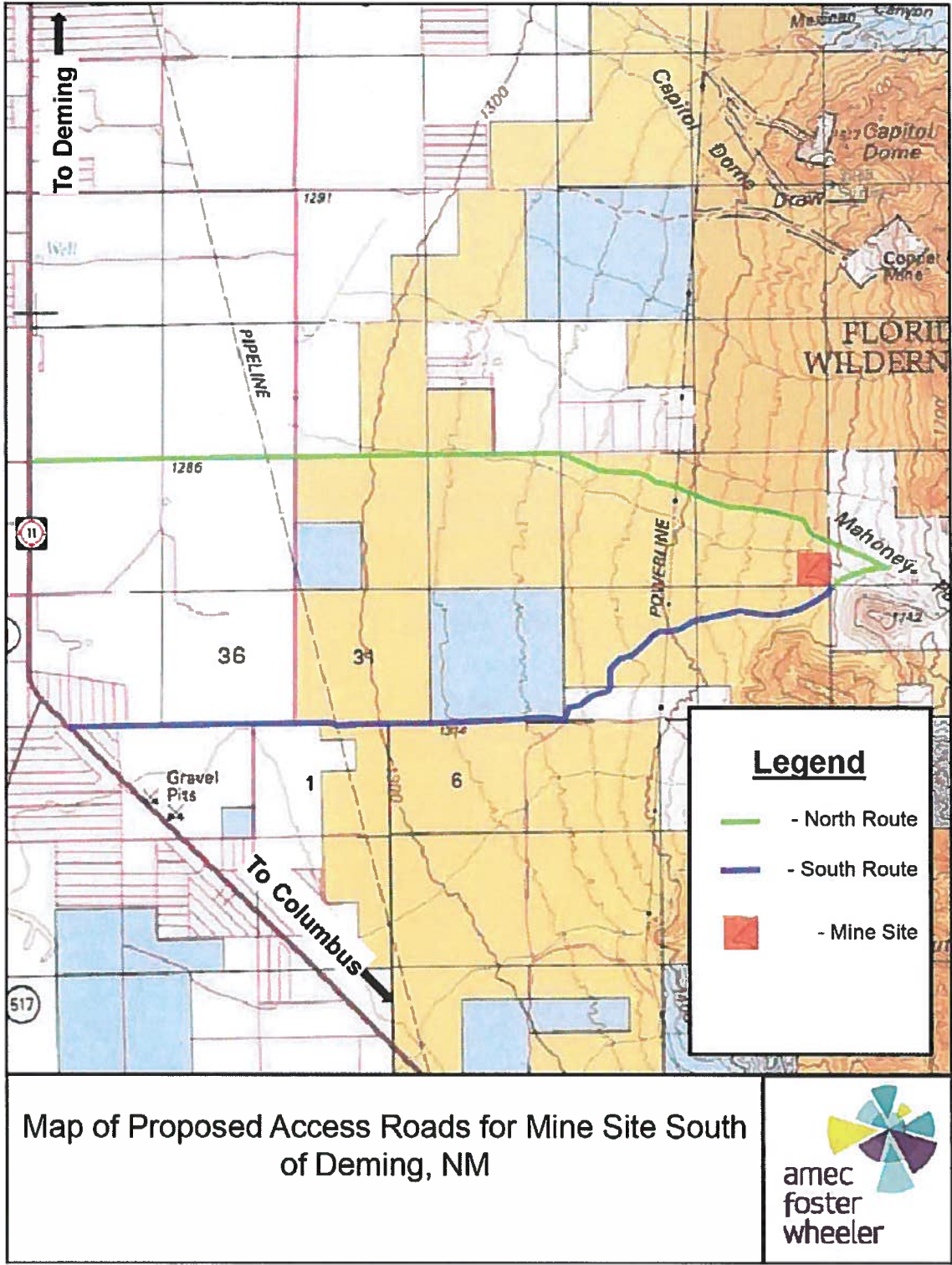
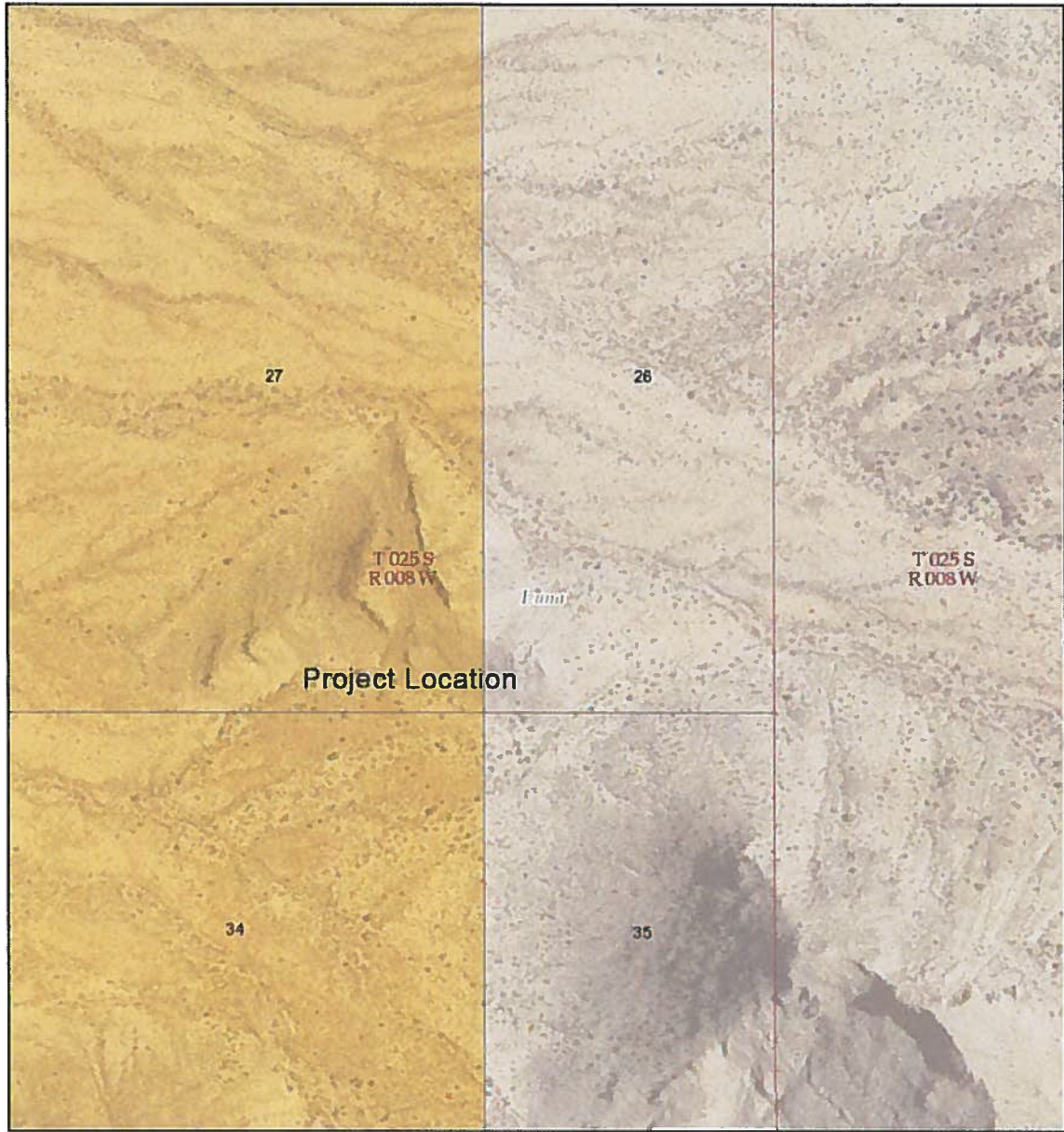
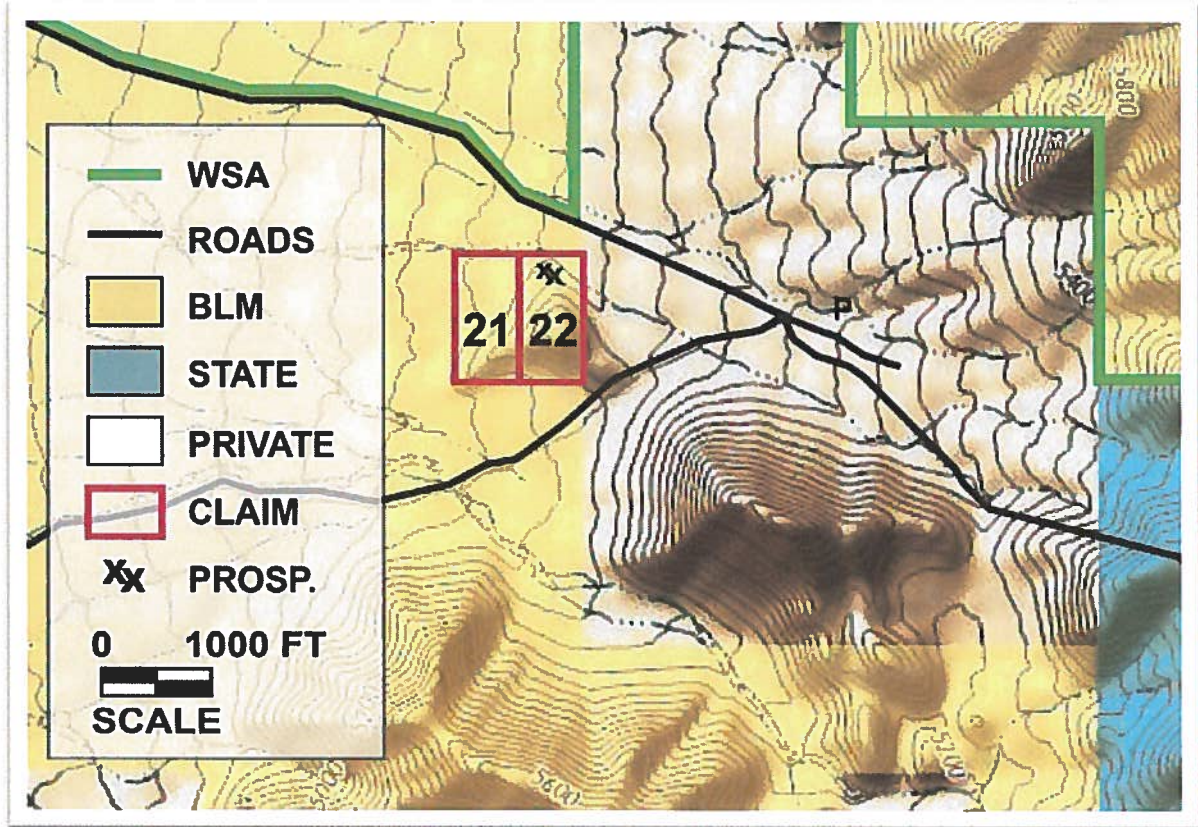

Figure 3. Land Management Agency



U.S. Bureau of Land Management

Figure 4. Claim Boundaries



3.8 Proposed Productive Post-Mining Land Use

Major land uses occurring in the vicinity of the mine area are mining, grazing, wildlife habitat, watershed, and recreation. Following closure, the mine area would continue to support mineral development, grazing, wildlife habitat, watershed, and recreation. Land use in the project area will not change from pre-mining approved purposes and the project area will continue to support these approved uses. Reclamation and closure of the disturbed area will result in post-mining land uses that will be sustainable and will be consistent with uses currently approved. Mining, grazing, recreation and wildlife habitat are the designations consistent with the surrounding land uses of the site, and will be appropriate for the site upon reclamation. The Reclamation and Closure Plan is designed to re-establish grazing in the area and allow for long-term use of the reclaimed areas by wildlife known to historically use the area without affecting the potential for other uses such as mining and recreation.

This page intentionally left blank

4.0 MONITORING PLAN [3809.401(b)(4)]

The operation is designed to produce zero discharge. As such, sediment control is an important design feature at the site. The only sedimentation that may be produced will be from surface water runoff from several on-site sources including the mining areas and any rock stockpiles.

A SWPPP will be developed for construction and maintained during operation. Sediment control will be achieved by the use of BMPs including regrading, seeding and mulching, silt fences, straw bale dams, diversion ditches with energy dissipaters, and rock check dams at appropriate locations during construction and operation. Diversion structures, including existing structures, will divert run-on away from disturbed areas. All sediment control structures will be monitored and maintained on a regular basis. During operations, all runoff from the plant site will be directed into impacted storm water impoundments and other ponds, as discussed below. During reclamation, all areas where water ponds will be re-contoured and graded, surfaces covered with top dressing, and vegetated.

4.1 Monitoring Devices

BMPs will be used to limit erosion and reduce sediment in runoff from the project disturbed areas during construction, operations, and reclamation. Structural and operational BMPs will be used to minimize erosion and control sediment. Disturbance will be limited to preserve existing vegetation to the maximum extent possible. Following construction activities, areas such as cut and fill embankments will be seeded as soon as practicable and safe. Revegetation of disturbed areas will reduce the potential for wind and water erosion. Concurrent reclamation will be utilized to the extent practicable to accelerate revegetation of disturbed areas. All sediment and erosion control measures will be inspected periodically and repairs performed as needed. Additional details regarding BMPs will be included in the SWPPP permit required for mine construction and operation.

4.2 Sampling Parameters and Frequency

There are no non-point discharges anticipated that will require monitoring. However, non-point sources will be managed to the extent they may occur during resource verification, mining development, mining or reclamation with the use of BMPs including such things as seeding and mulching of disturbed areas, silt fences, straw bale check dams, diversion ditches with energy dissipaters, and rock check dams, as necessary.

4.3 Analytical Methods

No analysis is required.

4.4 Reporting Procedures

Reports shall be completed in accordance with project plans and requirements.

5.0 INTERIM MANAGEMENT PLAN [3809.401(b)(5)]

5.1 Schedule of Anticipated Periods of Temporary Closure [3809.401(b)(5)(vi)]

No temporary closures are anticipated during the execution of this project. If a temporary closure is required due to mechanical, operational, or weather requirements, the following measures will be taken:

- Excavations and workings will be stabilized;
- Toxic or deleterious materials will be removed from the site;
- Equipment, supplies and structures will be stored or removed;
- Project area will be monitored to maintain a safe and clean condition; and,
- Site conditions will be inspected every 14 days or following periods of rainfall exceeding 0.25 inches in a 24-hour period.

5.2 Plans for Monitoring Site Conditions during Periods of Non-Operation [3809.401(b)(5)(v)]

Site conditions will be inspected every 14 days or following periods of rainfall exceeding 0.25 inches in a 24-hour period.

5.2.1 Measures to Stabilize Excavations and Workings [3809.401(b)(5)(i)]

When possible, final and interim reclamation would be performed concurrently with resource verification activities. When re-contoured, the disturbed areas will be graded to promote non-erosive runoff, and would be vegetated. To the extent feasible, any remaining disturbed areas will be shaped to blend with the surrounding topography and seeded.

Reclamation will consist of re-contouring and seeding. Regrading will consist of redistributing fill slopes back onto the cut portion of roads to return the area to near pre-disturbance topography. Culverts are not anticipated on resource verification roads, and therefore, it is not anticipated that the removal any culverts during re-contouring of the roads will be necessary. However, if installation of culverts along a primary access road is necessary for resource verification or ore hauling during mining, they will be left in place if permitted by BLM as they are likely to have long-term benefits for site access. Regrading would, to the extent practical, re-establish pre-disturbance topography and drainage, and provide slopes that would, in conjunction with revegetation, control erosion. The re-contoured surface will be seeded with 13 pounds pure live seed per acre.

5.2.2 Measures to Isolate or Control Toxic or Deleterious Materials [3809.401(b)(5)(ii)]

All refuse generated by the Project will be disposed of at an authorized landfill facility off-site, consistent with applicable regulations. No refuse will be disposed of on-site. Water

and/or nontoxic drill hole abandonment materials, including abantonite, Alcomer 120L, bentonite, EZ-mud, polyplus, and super plug, will be utilized as necessary during drilling and will be stored at the Project Area.

Hazardous and regulated materials utilized at the Project Area will include diesel fuel, gasoline, and lubricating grease. All containers of hazardous substances will be labeled and handled in accordance with the NMDOT and MSHA. In the event hazardous or regulated materials, such as diesel fuel, are spilled, measures will be taken to control the spill, and they will be cleaned up in a timely manner. After clean up, the oil, toxic fluids, or chemicals and any contaminated material will be removed from the site and disposed of at an approved disposal facility. Self-contained, portable, chemical toilets will be used for human waste. The human waste and toilet chemicals will not be buried on site.

5.2.3 Provisions for the Storage or Removal of Equipment, Supplies, and Structures [3809.401(b)(5)(iii)]

Not applicable.

5.2.4 Measures to Maintain the Project Area in a Safe and Clean Condition [3809.401(b)(5)(iv)]

The Project Area will remain trash free and will be left in a safe condition. Routine road maintenance may be required and will consist of smoothing ruts, filling holes with fill material, grading, and re-establishing waterbars when necessary.

Periods of non-operation greater than 120 days are not anticipated; however, if temporary closures are required, the drill rig will vacate the Project Area and sumps will be adequately fenced. Once the sumps have dried out, they will be backfilled.

The BLM and MMD will be notified in writing within 90 days after work is suspended at the operation for more than 120 days. The Notice will state the nature and the reason for the suspension of work, the anticipated duration of the suspension, and any event that will reasonably be expected to result in either the resumption of activities or the abandonment of the operation.

All trash will be hauled off site and there will be no resource verification or mining materials left on site at the conclusion of operations. All drill sites will be patrolled with hand rake and shovel after Project completion to scatter and cover any cuttings piles, fill ruts, and to perform general clean up. No core samples will be left on-site after the completion of Project activities.

6.0 RECLAMATION COST ESTIMATE [3809.401(d)]

A preliminary reclamation cost estimate is included here, and a final reclamation cost estimate will be submitted in the future as Appendix D. As required by 43 CFR 3809.552, a complete reclamation cost estimate will be prepared for the entire mine project during evaluation or upon completion of the requirements of the National Environmental Policy Act (NEPA). The planned cost estimating effort will utilize industry acceptable software to facilitate accuracy, completeness, and consistency in the calculation of costs for mine site reclamation.

The total reclamation cost estimate for the 15 acres of authorized disturbance within the Project Area associated with proposed Phase I surface disturbance will be calculated and submitted initially, and AmMg anticipates that the total reclamation cost estimate will be submitted in coordination with BLM and MMD in connection with determining the appropriate financial assurance to be submitted for the Project. The financial assurance will be posted in the approved amount in order to cover this Plan upon receiving concurrence from the BLM and MMD that the amount is satisfactory.

6.1 Proposed Reclamation Activities

The primary closure and reclamation activities to be undertaken for this Project include:

- Re-contouring disturbed areas;
- Drill hole plugging and abandonment; and
- Seeding disturbed areas to establish vegetation.

Reclamation costs will be estimated for the activities described in the Reclamation Plan. The estimated costs will be based on Davis-Bacon Act labor wage rates and local equipment rental rates and 40 hours (1 equipment operator and 2 laborers) for the estimated time to complete the tasks and the anticipated costs of materials that would be required for hydro seeding. Per BLM guidelines, these separate cost categories (manpower, equipment, and materials) will be provided as separate line items for each reclamation disturbance category. The costs will be based on reclamation of 15 acres and a 40 hour work week to complete.

Table 9. Preliminary Reclamation Cost Estimate

Project Component	Manpower	Equipment	Material	Total
Mine Planning, including Resource verification Roads and Drill Pads	\$1,783	\$3,800	\$65,340	\$70,923.00

7.0 REFERENCES

- Ackerly, Neal W. (2016), *Class III Cultural Resources Survey of American Magnesium LLC Proposed Quarry Development, Luna County, NM*, Dos Rios Consultants, Inc.
- Christensen, Todd S. (2007), *Guidance for implementing the Potential Fossil Yield Classification (PFYC) System*, United States Department of the Interior Bureau of Land Management Instructional Memorandum No. 2008-009, Attachment 2
- Clemens, Russel E. (1985), *Geology of the South Peak Quadrangle, Luna County, New Mexico*. New Mexico Bureau of Mines & Mineral Resources, Geologic Map 59
- Contaldo, Gregory J., Mueller, Jerry E. (1991), Earth Fissures of the Mimbres Basin, Southwestern, New Mexico, *New Mexico Geology* Volume 13, No. 4, pp. 69-74
- Cuddy, Alan S., Keyes, Eric (2011), *Groundwater Model of the Mimbres Basin, Luna, Grant, Sierra and Doña Ana Counties, New Mexico*, New Mexico Office of the State Engineer Hydrology Bureau Technical Report 11-1, January 2011
- Daniels, Mark, Pohs, Keith (2016), *Biological Evaluation of the Proposed Foothills Dolomite Quarry South of Deming, Luna County, New Mexico*, Prepared for the U.S. Bureau of Land Management by Envirosystems Management, Inc.
- Finch, Stephen T. Jr., McCoy, Annie, & Melis, Erwin, (2008), *Geologic Controls of Groundwater Flow in the Mimbres Basin, Southwestern New Mexico*, New Mexico Geologic Society Guidebook, 59th Field Conference, *Geology of the Gila Wilderness – Silver City Area*, pp. 189-198
- Neher, Raymond E., Buchanan, William A. (1980), *Soil Survey of Luna County, New Mexico*, U.S. Department of Agriculture (USDA) Soil Conservation Service
- Ruppel, Stephen C., *The Fusselman of the Permian Basin: Patterns in Depositional and Diagenetic Facies Development on a Stable Platform During the Late Ordovician-Early Silurian Icehouse*, Bureau of Economic Geology, Jackson School of Geosciences, The University of Texas at Austin