

State of New Mexico  
Energy, Minerals and Natural Resources Department

---

**Susana Martinez**  
Governor

**Ken McQueen**  
Cabinet Secretary

**Matthias Sayer**  
Deputy Cabinet Secretary

**Fernando Martinez, Director**  
Mining and Minerals Division



November 13, 2018

Governor Kurt Riley  
Pueblo of Acoma  
P.O. Box 309  
Acoma, NM 87034

**Re: Request for Comments on Minimal Impact Mining Application, Modification 18-1 Expansion of Permit Area, Brie I Mine, McKinley County, New Mexico, Permit No. MK039MN**

Dear Governor Riley,

The Mining and Minerals Division (MMD) of the New Mexico Energy, Minerals, and Natural Resources Department has received an application from Miocene, LLC ("Permittee") to modify the permit area for the Brie I Mine in accordance with 19.10.3.304 NMAC of the New Mexico Mining Act (NMSA 1978, §69-36-1 et seq.). The proposed modification ("Modification 18-1") is located in portions of Section 7, Township 19 North, Range 5 West in McKinley County. The project proposes to increase the permit area by approximately 140 acres. The area proposed for expansion is on land managed by the Bureau of Land Management ("BLM") Farmington Field Office.

"Minimal Impact New Mining" means disturbance will not exceed a total of up to 40 acres at any given time for humate mines, which therefore limits impact to the environment. Please see the attached map of the area proposed for permit area expansion. The application received by MMD can be viewed in its entirety by visiting the MMD website at <http://www.emnrd.state.nm.us/MMD/MARP/MK039MNMod18-1.html>

As part of the application process, MMD is requesting comments from the New Mexico Department of Cultural Affairs, Historic Preservation Division ("HPD") on this modification request from the Permittee. Additionally, MMD is also requesting comments from the BLM Farmington Field Office, which may conduct an independent review of archaeological resources in the area proposed for permit expansion. Results of any archaeological surveys within Section 7, if any, may be obtained from the BLM Farmington Field Office upon request.

If there are known cultural resources in the vicinity of this project that your tribe is aware of, please provide any comments and concerns to MMD by December 21, 2018. Please contact me at (505) 476-3435, or David Ennis of my staff at (505) 476-3434 with any questions or if you wish to meet to discuss the application.

Sincerely,

  
Fernando Martinez, Director  
Mining and Minerals Division

Enclosure (Project Vicinity Map)

cc: Project File (MK039MN, Modification 18-1)

State of New Mexico  
Energy, Minerals and Natural Resources Department

**Susana Martinez**  
Governor

**Ken McQueen**  
Cabinet Secretary

**Matthias Sayer**  
Deputy Cabinet Secretary

**Fernando Martinez, Director**  
Mining and Minerals Division



November 13, 2018

Chairman Herman G. Honanie  
Hopi Tribe  
P.O. Box 123  
Kykotsmovi, AZ 86039

**Re: Request for Comments on Minimal Impact Mining Application, Modification 18-1 Expansion of Permit Area, Brie I Mine, McKinley County, New Mexico, Permit No. MK039MN**

Dear Chairman Honanie,

The Mining and Minerals Division (MMD) of the New Mexico Energy, Minerals, and Natural Resources Department has received an application from Miocene, LLC ("Permittee") to modify the permit area for the Brie I Mine in accordance with 19.10.3.304 NMAC of the New Mexico Mining Act (NMSA 1978, §69-36-1 et seq.). The proposed modification ("Modification 18-1") is located in portions of Section 7, Township 19 North, Range 5 West in McKinley County. The project proposes to increase the permit area by approximately 140 acres. The area proposed for expansion is on land managed by the Bureau of Land Management ("BLM") Farmington Field Office.

"Minimal Impact New Mining" means disturbance will not exceed a total of up to 40 acres at any given time for hard rock mines, which therefore limits impact to the environment. Please see the attached map of the area proposed for permit area expansion. The application received by MMD can be viewed in its entirety by visiting the MMD website at <http://www.emnrd.state.nm.us/MMD/MARP/MK039MNMod18-1.html>

As part of the application process, MMD is requesting comments from the New Mexico Department of Cultural Affairs, Historic Preservation Division ("HPD") on this modification request from the Permittee. Additionally, MMD is also requesting comments from the BLM Farmington Field Office, which may conduct an independent review of archaeological resources in the area proposed for permit expansion. Results of any archaeological surveys within Section 7, if any, may be obtained from the BLM Farmington Field Office upon request.

If there are known cultural resources in the vicinity of this project that your tribe is aware of, please provide any comments and concerns to MMD by December 21, 2018. Please contact me at (505) 476-3435, or David Ennis of my staff at (505) 476-3434 with any questions or if you wish to meet to discuss the application.

Sincerely,

Fernando Martinez, Director  
Mining and Minerals Division

Enclosure (Project Vicinity Map)

cc: Project File (MK039MN, Modification 18-1)

State of New Mexico  
Energy, Minerals and Natural Resources Department

---

**Susana Martinez**  
Governor

**Ken McQueen**  
Cabinet Secretary

**Matthias Sayer**  
Deputy Cabinet Secretary

**Fernando Martinez, Director**  
Mining and Minerals Division



November 13, 2018

Director Leigh Kuwanwisiwma  
Hopi Cultural Preservation Office  
P.O. Box 123  
Kykotsmovi, AZ 86039

**Re: Request for Comments on Minimal Impact Mining Application, Modification 18-1 Expansion of Permit Area, Brie I Mine, McKinley County, New Mexico, Permit No. MK039MN**

Dear Director Kuwanwisiwma,

The Mining and Minerals Division (MMD) of the New Mexico Energy, Minerals, and Natural Resources Department has received an application from Miocene, LLC ("Permittee") to modify the permit area for the Brie I Mine in accordance with 19.10.3.304 NMAC of the New Mexico Mining Act (NMSA 1978, §69-36-1 et seq.). The proposed modification ("Modification 18-1") is located in portions of Section 7, Township 19 North, Range 5 West in McKinley County. The project proposes to increase the permit area by approximately 140 acres. The area proposed for expansion is on land managed by the Bureau of Land Management ("BLM") Farmington Field Office.

"Minimal Impact New Mining" means disturbance will not exceed a total of up to 40 acres at any given time for humate mines, which therefore limits impact to the environment. Please see the attached map of the area proposed for permit area expansion. The application received by MMD can be viewed in its entirety by visiting the MMD website at <http://www.emnrd.state.nm.us/MMD/MARP/MK039MNMod18-1.html>

As part of the application process, MMD is requesting comments from the New Mexico Department of Cultural Affairs, Historic Preservation Division ("HPD") on this modification request from the Permittee. Additionally, MMD is also requesting comments from the BLM Farmington Field Office, which may conduct an independent review of archaeological resources in the area proposed for permit expansion. Results of any archaeological surveys within Section 7, if any, may be obtained from the BLM Farmington Field Office upon request.

If there are known cultural resources in the vicinity of this project that your tribe is aware of, please provide any comments and concerns to MMD by December 21, 2018. Please contact me at (505) 476-3435, or David Ennis of my staff at (505) 476-3434 with any questions or if you wish to meet to discuss the application.

Sincerely,

Fernando Martinez, Director  
Mining and Minerals Division

Enclosure (Project Vicinity Map)

cc: Project File (MK039MN, Modification 18-1)

State of New Mexico  
Energy, Minerals and Natural Resources Department

**Susana Martinez**  
Governor

**Ken McQueen**  
Cabinet Secretary

**Matthias Sayer**  
Deputy Cabinet Secretary

**Fernando Martinez, Director**  
Mining and Minerals Division



November 13, 2018

Governor E. Paul Torres  
Pueblo of Isleta  
P.O. Box 1270  
Isleta Pueblo, NM 87022

**Re: Request for Comments on Minimal Impact Mining Application, Modification 18-1 Expansion of Permit Area, Brie I Mine, McKinley County, New Mexico, Permit No. MK039MN**

Dear Governor Torres,

The Mining and Minerals Division (MMD) of the New Mexico Energy, Minerals, and Natural Resources Department has received an application from Miocene, LLC ("Permittee") to modify the permit area for the Brie I Mine in accordance with 19.10.3.304 NMAC of the New Mexico Mining Act (NMSA 1978, §69-36-1 et seq.). The proposed modification ("Modification 18-1") is located in portions of Section 7, Township 19 North, Range 5 West in McKinley County. The project proposes to increase the permit area by approximately 140 acres. The area proposed for expansion is on land managed by the Bureau of Land Management ("BLM") Farmington Field Office.

"Minimal Impact New Mining" means disturbance will not exceed a total of up to 40 acres at any given time for hard rock mines, which therefore limits impact to the environment. Please see the attached map of the area proposed for permit area expansion. The application received by MMD can be viewed in its entirety by visiting the MMD website at <http://www.emnrd.state.nm.us/MMD/MARP/MK039MNMod18-1.html>

As part of the application process, MMD is requesting comments from the New Mexico Department of Cultural Affairs, Historic Preservation Division ("HPD") on this modification request from the Permittee. Additionally, MMD is also requesting comments from the BLM Farmington Field Office, which may conduct an independent review of archaeological resources in the area proposed for permit expansion. Results of any archaeological surveys within Section 7, if any, may be obtained from the BLM Farmington Field Office upon request.

If there are known cultural resources in the vicinity of this project that your tribe is aware of, please provide any comments and concerns to MMD by December 21, 2018. Please contact me at (505) 476-3435, or David Ennis of my staff at (505) 476-3434 with any questions or if you wish to meet to discuss the application.

Sincerely,

Fernando Martinez, Director  
Mining and Minerals Division

Enclosure (Project Vicinity Map)

cc: Project File (MK039MN, Modification 18-1)

State of New Mexico  
Energy, Minerals and Natural Resources Department

---

**Susana Martinez**  
Governor

**Ken McQueen**  
Cabinet Secretary

**Matthias Sayer**  
Deputy Cabinet Secretary

**Fernando Martinez, Director**  
Mining and Minerals Division



November 13, 2018

Dr. Henry Walt  
Pueblo of Isleta, THPO  
P.O. Box 1270  
Isleta Pueblo, NM 87022

**Re: Request for Comments on Minimal Impact Mining Application, Modification 18-1 Expansion of Permit Area, Brie I Mine, McKinley County, New Mexico, Permit No. MK039MN**

Dear Dr. Walt,

The Mining and Minerals Division (MMD) of the New Mexico Energy, Minerals, and Natural Resources Department has received an application from Miocene, LLC ("Permittee") to modify the permit area for the Brie I Mine in accordance with 19.10.3.304 NMAC of the New Mexico Mining Act (NMSA 1978, §69-36-1 et seq.). The proposed modification ("Modification 18-1") is located in portions of Section 7, Township 19 North, Range 5 West in McKinley County. The project proposes to increase the permit area by approximately 140 acres. The area proposed for expansion is on land managed by the Bureau of Land Management ("BLM") Farmington Field Office.

"Minimal Impact New Mining" means disturbance will not exceed a total of up to 40 acres at any given time for humate mines, which therefore limits impact to the environment. Please see the attached map of the area proposed for permit area expansion. The application received by MMD can be viewed in its entirety by visiting the MMD website at <http://www.emnrd.state.nm.us/MMD/MARP/MK039MNMod18-1.html>

As part of the application process, MMD is requesting comments from the New Mexico Department of Cultural Affairs, Historic Preservation Division ("HPD") on this modification request from the Permittee. Additionally, MMD is also requesting comments from the BLM Farmington Field Office, which may conduct an independent review of archaeological resources in the area proposed for permit expansion. Results of any archaeological surveys within Section 7, if any, may be obtained from the BLM Farmington Field Office upon request.

If there are known cultural resources in the vicinity of this project that your tribe is aware of, please provide any comments and concerns to MMD by December 21, 2018. Please contact me at (505) 476-3435, or David Ennis of my staff at (505) 476-3434 with any questions or if you wish to meet to discuss the application.

Sincerely,

Fernando Martinez, Director  
Mining and Minerals Division

Enclosure (Project Vicinity Map)

cc: Project File (MK039MN, Modification 18-1)

State of New Mexico  
Energy, Minerals and Natural Resources Department

---

**Susana Martinez**  
Governor

**Ken McQueen**  
Cabinet Secretary

**Matthias Sayer**  
Deputy Cabinet Secretary

**Fernando Martinez, Director**  
Mining and Minerals Division



November 13, 2018

Governor Virgil A. Siow  
Pueblo of Laguna  
P.O. Box 194  
Laguna Pueblo, NM 87026

**Re: Request for Comments on Minimal Impact Mining Application, Modification 18-1 Expansion of Permit Area, Brie I Mine, McKinley County, New Mexico, Permit No. MK039MN**

Dear Governor Siow,

The Mining and Minerals Division (MMD) of the New Mexico Energy, Minerals, and Natural Resources Department has received an application from Miocene, LLC ("Permittee") to modify the permit area for the Brie I Mine in accordance with 19.10.3.304 NMAC of the New Mexico Mining Act (NMSA 1978, §69-36-1 et seq.). The proposed modification ("Modification 18-1") is located in portions of Section 7, Township 19 North, Range 5 West in McKinley County. The project proposes to increase the permit area by approximately 140 acres. The area proposed for expansion is on land managed by the Bureau of Land Management ("BLM") Farmington Field Office.

"Minimal Impact New Mining" means disturbance will not exceed a total of up to 40 acres at any given time for humate mines, which therefore limits impact to the environment. Please see the attached map of the area proposed for permit area expansion. The application received by MMD can be viewed in its entirety by visiting the MMD website at <http://www.emnrd.state.nm.us/MMD/MARP/MK039MNMod18-1.html>

As part of the application process, MMD is requesting comments from the New Mexico Department of Cultural Affairs, Historic Preservation Division ("HPD") on this modification request from the Permittee. Additionally, MMD is also requesting comments from the BLM Farmington Field Office, which may conduct an independent review of archaeological resources in the area proposed for permit expansion. Results of any archaeological surveys within Section 7, if any, may be obtained from the BLM Farmington Field Office upon request.

If there are known cultural resources in the vicinity of this project that your tribe is aware of, please provide any comments and concerns to MMD by December 21, 2018. Please contact me at (505) 476-3435, or David Ennis of my staff at (505) 476-3434 with any questions or if you wish to meet to discuss the application.

Sincerely,

Fernando Martinez, Director  
Mining and Minerals Division

Enclosure (Project Vicinity Map)

cc: Project File (MK039MN, Modification 18-1)

State of New Mexico  
Energy, Minerals and Natural Resources Department

**Susana Martinez**  
Governor

**Ken McQueen**  
Cabinet Secretary

**Matthias Sayer**  
Deputy Cabinet Secretary

**Fernando Martinez, Director**  
Mining and Minerals Division



November 13, 2018

Mr. Gaylord Siow  
Pueblo of Laguna, THPO  
P.O. Box 194  
Laguna Pueblo, NM 87026

**Re: Request for Comments on Minimal Impact Mining Application, Modification 18-1 Expansion of Permit Area, Brie I Mine, McKinley County, New Mexico, Permit No. MK039MN**

Dear Mr. Siow,

The Mining and Minerals Division (MMD) of the New Mexico Energy, Minerals, and Natural Resources Department has received an application from Miocene, LLC ("Permittee") to modify the permit area for the Brie I Mine in accordance with 19.10.3.304 NMAC of the New Mexico Mining Act (NMSA 1978, §69-36-1 et seq.). The proposed modification ("Modification 18-1") is located in portions of Section 7, Township 19 North, Range 5 West in McKinley County. The project proposes to increase the permit area by approximately 140 acres. The area proposed for expansion is on land managed by the Bureau of Land Management ("BLM") Farmington Field Office.

"Minimal Impact New Mining" means disturbance will not exceed a total of up to 40 acres at any given time for humate mines, which therefore limits impact to the environment. Please see the attached map of the area proposed for permit area expansion. The application received by MMD can be viewed in its entirety by visiting the MMD website at <http://www.emnrd.state.nm.us/MMD/MARP/MK039MNMod18-1.html>

As part of the application process, MMD is requesting comments from the New Mexico Department of Cultural Affairs, Historic Preservation Division ("HPD") on this modification request from the Permittee. Additionally, MMD is also requesting comments from the BLM Farmington Field Office, which may conduct an independent review of archaeological resources in the area proposed for permit expansion. Results of any archaeological surveys within Section 7, if any, may be obtained from the BLM Farmington Field Office upon request.

If there are known cultural resources in the vicinity of this project that your tribe is aware of, please provide any comments and concerns to MMD by December 21, 2018. Please contact me at (505) 476-3435, or David Ennis of my staff at (505) 476-3434 with any questions or if you wish to meet to discuss the application.

Sincerely,

Fernando Martinez, Director  
Mining and Minerals Division

Enclosure (Project Vicinity Map)

cc: Project File (MK039MN, Modification 18-1)

State of New Mexico  
Energy, Minerals and Natural Resources Department

---

**Susana Martinez**  
Governor

**Ken McQueen**  
Cabinet Secretary

**Matthias Sayer**  
Deputy Cabinet Secretary

**Fernando Martinez, Director**  
Mining and Minerals Division



November 13, 2018

President Russell Begaye  
Navajo Nation  
P.O. Box 7440  
Window Rock, AZ 86515

**Re: Request for Comments on Minimal Impact Mining Application, Modification 18-1 Expansion of Permit Area, Brie I Mine, McKinley County, New Mexico, Permit No. MK039MN**

Dear President Begaye,

The Mining and Minerals Division (MMD) of the New Mexico Energy, Minerals, and Natural Resources Department has received an application from Miocene, LLC ("Permittee") to modify the permit area for the Brie I Mine in accordance with 19.10.3.304 NMAC of the New Mexico Mining Act (NMSA 1978, §69-36-1 et seq.). The proposed modification ("Modification 18-1") is located in portions of Section 7, Township 19 North, Range 5 West in McKinley County. The project proposes to increase the permit area by approximately 140 acres. The area proposed for expansion is on land managed by the Bureau of Land Management ("BLM") Farmington Field Office.

"Minimal Impact New Mining" means disturbance will not exceed a total of up to 40 acres at any given time for humate mines, which therefore limits impact to the environment. Please see the attached map of the area proposed for permit area expansion. The application received by MMD can be viewed in its entirety by visiting the MMD website at <http://www.emnrd.state.nm.us/MMD/MARP/MK039MNMod18-1.html>

As part of the application process, MMD is requesting comments from the New Mexico Department of Cultural Affairs, Historic Preservation Division ("HPD") on this modification request from the Permittee. Additionally, MMD is also requesting comments from the BLM Farmington Field Office, which may conduct an independent review of archaeological resources in the area proposed for permit expansion. Results of any archaeological surveys within Section 7, if any, may be obtained from the BLM Farmington Field Office upon request.

If there are known cultural resources in the vicinity of this project that your tribe is aware of, please provide any comments and concerns to MMD by December 21, 2018. Please contact me at (505) 476-3435, or David Ennis of my staff at (505) 476-3434 with any questions or if you wish to meet to discuss the application.

Sincerely,

Fernando Martinez, Director  
Mining and Minerals Division

Enclosure (Project Vicinity Map)

cc: Project File (MK039MN, Modification 18-1)



State of New Mexico  
Energy, Minerals and Natural Resources Department

---

**Susana Martinez**  
Governor

**Ken McQueen**  
Cabinet Secretary

**Matthias Sayer**  
Deputy Cabinet Secretary

**Fernando Martinez, Director**  
Mining and Minerals Division



November 13, 2018

Dr. Ora Marek-Martinez  
Navajo Nation, THPO  
P.O. Box 4950  
Window Rock, AZ 86515

**Re: Request for Comments on Minimal Impact Mining Application, Modification 18-1 Expansion of Permit Area, Brie I Mine, McKinley County, New Mexico, Permit No. MK039MN**

Dear Dr. Marek-Martinez,

The Mining and Minerals Division (MMD) of the New Mexico Energy, Minerals, and Natural Resources Department has received an application from Miocene, LLC ("Permittee") to modify the permit area for the Brie I Mine in accordance with 19.10.3.304 NMAC of the New Mexico Mining Act (NMSA 1978, §69-36-1 et seq.). The proposed modification ("Modification 18-1") is located in portions of Section 7, Township 19 North, Range 5 West in McKinley County. The project proposes to increase the permit area by approximately 140 acres. The area proposed for expansion is on land managed by the Bureau of Land Management ("BLM") Farmington Field Office.

"Minimal Impact New Mining" means disturbance will not exceed a total of up to 40 acres at any given time for humate mines, which therefore limits impact to the environment. Please see the attached map of the area proposed for permit area expansion. The application received by MMD can be viewed in its entirety by visiting the MMD website at <http://www.emnrd.state.nm.us/MMD/MARP/MK039MNMod18-1.html>

As part of the application process, MMD is requesting comments from the New Mexico Department of Cultural Affairs, Historic Preservation Division ("HPD") on this modification request from the Permittee. Additionally, MMD is also requesting comments from the BLM Farmington Field Office, which may conduct an independent review of archaeological resources in the area proposed for permit expansion. Results of any archaeological surveys within Section 7, if any, may be obtained from the BLM Farmington Field Office upon request.

If there are known cultural resources in the vicinity of this project that your tribe is aware of, please provide any comments and concerns to MMD by December 21, 2018. Please contact me at (505) 476-3435, or David Ennis of my staff at (505) 476-3434 with any questions or if you wish to meet to discuss the application.

Sincerely,

Fernando Martinez, Director  
Mining and Minerals Division

Enclosure (Project Vicinity Map)

cc: Project File (MK039MN, Modification 18-1)

State of New Mexico  
Energy, Minerals and Natural Resources Department

---

**Susana Martinez**  
Governor

**Ken McQueen**  
Cabinet Secretary

**Matthias Sayer**  
Deputy Cabinet Secretary

**Fernando Martinez, Director**  
Mining and Minerals Division



November 13, 2018

Governor Fredrick Vigil  
Pueblo of Tesuque  
Route 42, Box 360-T  
Santa Fe, NM 87506

**Re: Request for Comments on Minimal Impact Mining Application, Modification 18-1 Expansion of Permit Area, Brie I Mine, McKinley County, New Mexico, Permit No. MK039MN**

Dear Governor Vigil,

The Mining and Minerals Division (MMD) of the New Mexico Energy, Minerals, and Natural Resources Department has received an application from Miocene, LLC ("Permittee") to modify the permit area for the Brie I Mine in accordance with 19.10.3.304 NMAC of the New Mexico Mining Act (NMSA 1978, §69-36-1 et seq.). The proposed modification ("Modification 18-1") is located in portions of Section 7, Township 19 North, Range 5 West in McKinley County. The project proposes to increase the permit area by approximately 140 acres. The area proposed for expansion is on land managed by the Bureau of Land Management ("BLM") Farmington Field Office.

"Minimal Impact New Mining" means disturbance will not exceed a total of up to 40 acres at any given time for humate mines, which therefore limits impact to the environment. Please see the attached map of the area proposed for permit area expansion. The application received by MMD can be viewed in its entirety by visiting the MMD website at <http://www.emnrd.state.nm.us/MMD/MARP/MK039MNMod18-1.html>

As part of the application process, MMD is requesting comments from the New Mexico Department of Cultural Affairs, Historic Preservation Division ("HPD") on this modification request from the Permittee. Additionally, MMD is also requesting comments from the BLM Farmington Field Office, which may conduct an independent review of archaeological resources in the area proposed for permit expansion. Results of any archaeological surveys within Section 7, if any, may be obtained from the BLM Farmington Field Office upon request.

If there are known cultural resources in the vicinity of this project that your tribe is aware of, please provide any comments and concerns to MMD by December 21, 2018. Please contact me at (505) 476-3435, or David Ennis of my staff at (505) 476-3434 with any questions or if you wish to meet to discuss the application.

Sincerely,



Fernando Martinez, Director  
Mining and Minerals Division

Enclosure (Project Vicinity Map)

cc: Project File (MK039MN, Modification 18-1)

State of New Mexico  
Energy, Minerals and Natural Resources Department

**Susana Martinez**  
Governor

**Ken McQueen**  
Cabinet Secretary

**Matthias Sayer**  
Deputy Cabinet Secretary

**Fernando Martinez, Director**  
Mining and Minerals Division



November 13, 2018

Mr. Charles Dorame  
Pueblo of Tesuque, THPO  
Route 42, Box 360-T  
Santa Fe, NM 87506

**Re: Request for Comments on Minimal Impact Mining Application, Modification 18-1 Expansion of Permit Area, Brie I Mine, McKinley County, New Mexico, Permit No. MK039MN**

Dear Mr. Dorame,

The Mining and Minerals Division (MMD) of the New Mexico Energy, Minerals, and Natural Resources Department has received an application from Miocene, LLC ("Permittee") to modify the permit area for the Brie I Mine in accordance with 19.10.3.304 NMAC of the New Mexico Mining Act (NMSA 1978, §69-36-1 et seq.). The proposed modification ("Modification 18-1") is located in portions of Section 7, Township 19 North, Range 5 West in McKinley County. The project proposes to increase the permit area by approximately 140 acres. The area proposed for expansion is on land managed by the Bureau of Land Management ("BLM") Farmington Field Office.

"Minimal Impact New Mining" means disturbance will not exceed a total of up to 40 acres at any given time for humate mines, which therefore limits impact to the environment. Please see the attached map of the area proposed for permit area expansion. The application received by MMD can be viewed in its entirety by visiting the MMD website at <http://www.emnrd.state.nm.us/MMD/MARP/MK039MNMMod18-1.html>

As part of the application process, MMD is requesting comments from the New Mexico Department of Cultural Affairs, Historic Preservation Division ("HPD") on this modification request from the Permittee. Additionally MMD is also requesting comments from the BLM Farmington Field Office, which may conduct an independent review of archaeological resources in the area proposed for permit expansion. Results of any archaeological surveys within Section 7, if any, may be obtained from the BLM Farmington Field Office upon request.

If there are known cultural resources in the vicinity of this project that your tribe is aware of, please provide any comments and concerns to MMD by December 21, 2018. Please contact me at (505) 476-3435, or David Ennis of my staff at (505) 476-3434 with any questions or if you wish to meet to discuss the application.

Sincerely,

  
Fernando Martinez, Director  
Mining and Minerals Division

Enclosure (Project Vicinity Map)

cc: Project File (MK039MN, Modification 18-1)

State of New Mexico  
Energy, Minerals and Natural Resources Department

---

**Susana Martinez**  
Governor

**Ken McQueen**  
Cabinet Secretary

**Matthias Sayer**  
Deputy Cabinet Secretary

**Fernando Martinez, Director**  
Mining and Minerals Division



November 13, 2018

Chairman Ronnie Lupe  
White Mountain Apache Tribe  
P.O. Box 700  
Whiteriver, AZ 85941

**Re: Request for Comments on Minimal Impact Mining Application, Modification 18-1 Expansion of Permit Area, Brie I Mine, McKinley County, New Mexico, Permit No. MK039MN**

Dear Chairman Lupe,

The Mining and Minerals Division (MMD) of the New Mexico Energy, Minerals, and Natural Resources Department has received an application from Miocene, LLC ("Permittee") to modify the permit area for the Brie I Mine in accordance with 19.10.3.304 NMAC of the New Mexico Mining Act (NMSA 1978, §69-36-1 et seq.). The proposed modification ("Modification 18-1") is located in portions of Section 7, Township 19 North, Range 5 West in McKinley County. The project proposes to increase the permit area by approximately 140 acres. The area proposed for expansion is on land managed by the Bureau of Land Management ("BLM") Farmington Field Office.

"Minimal Impact New Mining" means disturbance will not exceed a total of up to 40 acres at any given time for humate mines, which therefore limits impact to the environment. Please see the attached map of the area proposed for permit area expansion. The application received by MMD can be viewed in its entirety by visiting the MMD website at <http://www.emnrd.state.nm.us/MMD/MARP/MK039MNMMod18-1.html>

As part of the application process, MMD is requesting comments from the New Mexico Department of Cultural Affairs, Historic Preservation Division ("HPD") on this modification request from the Permittee. Additionally, MMD is also requesting comments from the BLM Farmington Field Office, which may conduct an independent review of archaeological resources in the area proposed for permit expansion. Results of any archaeological surveys within Section 7, if any, may be obtained from the BLM Farmington Field Office upon request.

If there are known cultural resources in the vicinity of this project that your tribe is aware of, please provide any comments and concerns to MMD by December 21, 2018. Please contact me at (505) 476-3435, or David Ennis of my staff at (505) 476-3434 with any questions or if you wish to meet to discuss the application.

Sincerely,

Fernando Martinez, Director  
Mining and Minerals Division

Enclosure (Project Vicinity Map)

cc: Project File (MK039MN, Modification 18-1)

State of New Mexico  
Energy, Minerals and Natural Resources Department

**Susana Martinez**  
Governor

**Ken McQueen**  
Cabinet Secretary

**Matthias Sayer**  
Deputy Cabinet Secretary

**Fernando Martinez, Director**  
Mining and Minerals Division



November 13, 2018

Mr. Mark Altaha  
White Mountain Apache Tribe, THPO  
P.O. Box 700  
Whiteriver, AZ 85941

**Re: Request for Comments on Minimal Impact Mining Application, Modification 18-1 Expansion of Permit Area, Brie I Mine, McKinley County, New Mexico, Permit No. MK039MN**

Dear Mr. Altaha,

The Mining and Minerals Division (MMD) of the New Mexico Energy, Minerals, and Natural Resources Department has received an application from Miocene, LLC ("Permittee") to modify the permit area for the Brie I Mine in accordance with 19.10.3.304 NMAC of the New Mexico Mining Act (NMSA 1978, §69-36-1 et seq.). The proposed modification ("Modification 18-1") is located in portions of Section 7, Township 19 North, Range 5 West in McKinley County. The project proposes to increase the permit area by approximately 140 acres. The area proposed for expansion is on land managed by the Bureau of Land Management ("BLM") Farmington Field Office.

"Minimal Impact New Mining" means disturbance will not exceed a total of up to 40 acres at any given time for humate mines, which therefore limits impact to the environment. Please see the attached map of the area proposed for permit area expansion. The application received by MMD can be viewed in its entirety by visiting the MMD website at <http://www.emnrd.state.nm.us/MMD/MARP/MK039MNMod18-1.html>

As part of the application process, MMD is requesting comments from the New Mexico Department of Cultural Affairs, Historic Preservation Division ("HPD") on this modification request from the Permittee. Additionally, MMD is also requesting comments from the BLM Farmington Field Office, which may conduct an independent review of archaeological resources in the area proposed for permit expansion. Results of any archaeological surveys within Section 7, if any, may be obtained from the BLM Farmington Field Office upon request.

If there are known cultural resources in the vicinity of this project that your tribe is aware of, please provide any comments and concerns to MMD by December 21, 2018. Please contact me at (505) 476-3435, or David Ernis of my staff at (505) 476-3434 with any questions or if you wish to meet to discuss the application.

Sincerely,

Fernando Martinez, Director  
Mining and Minerals Division

Enclosure (Project Vicinity Map)

cc: Project File (MK039MN, Modification 18-1)

State of New Mexico  
Energy, Minerals and Natural Resources Department

**Susana Martinez**  
Governor

**Ken McQueen**  
Cabinet Secretary

**Matthias Sayer**  
Deputy Cabinet Secretary

**Fernando Martinez, Director**  
Mining and Minerals Division



November 13, 2018

Governor Val Panteah, Sr.  
Pueblo of Zuni  
P.O. Box 339  
Zuni, NM 87327

**Re: Request for Comments on Minimal Impact Mining Application, Modification 18-1 Expansion of Permit Area, Brie I Mine, McKinley County, New Mexico, Permit No. MK039MN**

Dear Governor Panteah, Sr.,

The Mining and Minerals Division (MMD) of the New Mexico Energy, Minerals, and Natural Resources Department has received an application from Miocene, LLC ("Permittee") to modify the permit area for the Brie I Mine in accordance with 19.10.3.304 NMAC of the New Mexico Mining Act (NMSA 1978, §69-36-1 et seq.). The proposed modification ("Modification 18-1") is located in portions of Section 7, Township 19 North, Range 5 West in McKinley County. The project proposes to increase the permit area by approximately 140 acres. The area proposed for expansion is on land managed by the Bureau of Land Management ("BLM") Farmington Field Office.

"Minimal Impact New Mining" means disturbance will not exceed a total of up to 40 acres at any given time for humate mines, which therefore limits impact to the environment. Please see the attached map of the area proposed for permit area expansion. The application received by MMD can be viewed in its entirety by visiting the MMD website at <http://www.emnrd.state.nm.us/MMD/MARP/MK039MNMod18-1.html>

As part of the application process, MMD is requesting comments from the New Mexico Department of Cultural Affairs, Historic Preservation Division ("HPD") on this modification request from the Permittee. Additionally, MMD is also requesting comments from the BLM Farmington Field Office, which may conduct an independent review of archaeological resources in the area proposed for permit expansion. Results of any archaeological surveys within Section 7, if any, may be obtained from the BLM Farmington Field Office upon request.

If there are known cultural resources in the vicinity of this project that your tribe is aware of, please provide any comments and concerns to MMD by December 21, 2018. Please contact me at (505) 476-3435, or David Ennis of my staff at (505) 476-3434 with any questions or if you wish to meet to discuss the application.

Sincerely,

Fernando Martinez, Director  
Mining and Minerals Division

Enclosure (Project Vicinity Map)

cc: Project File (MK039MN, Modification 18-1)

State of New Mexico  
Energy, Minerals and Natural Resources Department

**Susana Martinez**  
Governor

**Ken McQueen**  
Cabinet Secretary

**Matthias Sayer**  
Deputy Cabinet Secretary

**Fernando Martinez, Director**  
Mining and Minerals Division



November 13, 2018

Mr. Kurt Dongoske  
Pueblo of Zuni, THPO  
P.O. Box 1149  
Zuni, NM 87327

**Re: Request for Comments on Minimal Impact Mining Application, Modification 18-1 Expansion of Permit Area, Brie I Mine, McKinley County, New Mexico, Permit No. MK039MN**

Dear Mr. Dongoske,

The Mining and Minerals Division (MMD) of the New Mexico Energy, Minerals, and Natural Resources Department has received an application from Miocene, LLC ("Permittee") to modify the permit area for the Brie I Mine in accordance with 19.10.3.304 NMAC of the New Mexico Mining Act (NMSA 1978, §69-36-1 et seq.). The proposed modification ("Modification 18-1") is located in portions of Section 7, Township 19 North, Range 5 West in McKinley County. The project proposes to increase the permit area by approximately 140 acres. The area proposed for expansion is on land managed by the Bureau of Land Management ("BLM") Farmington Field Office.

"Minimal Impact New Mining" means disturbance will not exceed a total of up to 40 acres at any given time for humate mines, which therefore limits impact to the environment. Please see the attached map of the area proposed for permit area expansion. The application received by MMD can be viewed in its entirety by visiting the MMD website at <http://www.emnrd.state.nm.us/MMD/MARP/MK039MNMod18-1.html>

As part of the application process, MMD is requesting comments from the New Mexico Department of Cultural Affairs, Historic Preservation Division ("HPD") on this modification request from the Permittee. Additionally, MMD is also requesting comments from the BLM Farmington Field Office, which may conduct an independent review of archaeological resources in the area proposed for permit expansion. Results of any archaeological surveys within Section 7, if any, may be obtained from the BLM Farmington Field Office upon request.

If there are known cultural resources in the vicinity of this project that your tribe is aware of, please provide any comments and concerns to MMD by December 21, 2018. Please contact me at (505) 476-3435, or David Ennis of my staff at (505) 476-3434 with any questions or if you wish to meet to discuss the application.

Sincerely,

Fernando Martinez, Director  
Mining and Minerals Division

Enclosure (Project Vicinity Map)

cc: Project File (MK039MN, Modification 18-1)

State of New Mexico  
Energy, Minerals and Natural Resources Department

**Susana Martinez**  
Governor

**Ken McQueen**  
Cabinet Secretary

**Matthias Sayer**  
Deputy Cabinet Secretary

**Fernando Martinez, Director**  
Mining and Minerals Division



November 13, 2018

Mr. Charles Dorame  
Pueblo of Tesuque, THPO  
Route 42, Box 360-T  
Santa Fe, NM 87506

**Re: Request for Comments on Minimal Impact Mining Application, Modification 18-1 Expansion of Permit Area, Brie I Mine, McKinley County, New Mexico, Permit No. MK039MN**

Dear Mr. Dorame,

The Mining and Minerals Division (MMD) of the New Mexico Energy, Minerals, and Natural Resources Department has received an application from Miocene, LLC ("Permittee") to modify the permit area for the Brie I Mine in accordance with 19.10.3.304 NMAC of the New Mexico Mining Act (NMSA 1978, §69-36-1 et seq.). The proposed modification ("Modification 18-1") is located in portions of Section 7, Township 19 North, Range 5 West in McKinley County. The project proposes to increase the permit area by approximately 140 acres. The area proposed for expansion is on land managed by the Bureau of Land Management ("BLM") Farmington Field Office.

"Minimal Impact New Mining" means disturbance will not exceed a total of up to 40 acres at any given time for humate mines, which therefore limits impact to the environment. Please see the attached map of the area proposed for permit area expansion. The application received by MMD can be viewed in its entirety by visiting the MMD website at <http://www.emnrd.state.nm.us/MMD/MARP/MK039MNMod18-1.html>

As part of the application process, MMD is requesting comments from the New Mexico Department of Cultural Affairs, Historic Preservation Division ("HPD") on this modification request from the Permittee. Additionally, MMD is also requesting comments from the BLM Farmington Field Office, which may conduct an independent review of archaeological resources in the area proposed for permit expansion. Results of any archaeological surveys within Section 7, if any, may be obtained from the BLM Farmington Field Office upon request.

If there are known cultural resources in the vicinity of this project that your tribe is aware of, please provide any comments and concerns to MMD by December 21, 2018. Please contact me at (505) 476-3435, or David Erinis of my staff at (505) 476-3434 with any questions or if you wish to meet to discuss the application.

Sincerely,

Fernando Martinez, Director  
Mining and Minerals Division

Enclosure (Project Vicinity Map)

cc: Project File (MK039MN, Modification 18-1)



Section 7, 19N, Range 5W  
Revised Area of Interest

N

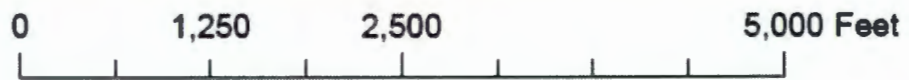
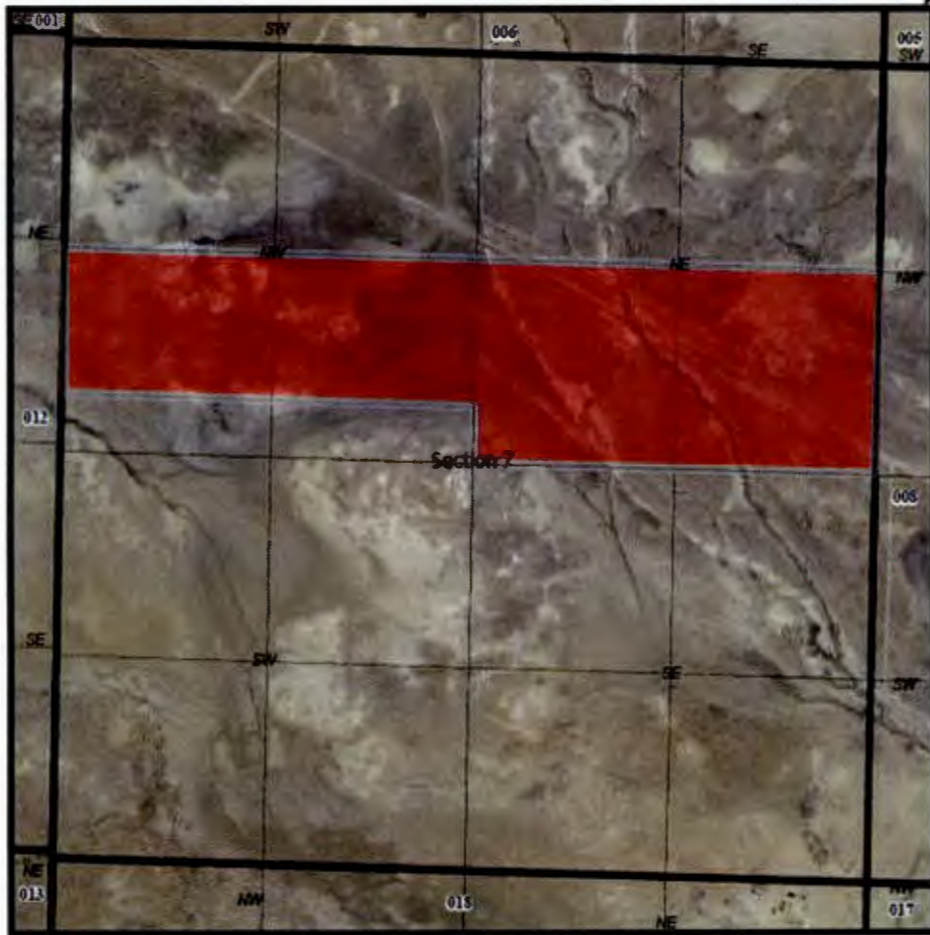

1:10,000