

DJ Ennis

Mining and Minerals Division

1220 South St. Francis Drive

Santa Fe, NM 87505

Dear Mr. Ennis,

This letter is intended to serve as a formal request for modification of the Brie I Mine permit (MK039MN) to include portions of Section 7, Township 19N, Range 5W. The area proposed for inclusion is administered by the Bureau of Land Management-Farmington Field Office (BLM-FFO). A map of the project area has been attached to this letter. Miocene will coordinate with BLM-FFO and EMNRD-MMD to ensure permitting requirements are met to the satisfaction of both entities.

Please let me know if you have any questions or comments.

Best regards,

Kris Lindgren

Section 7, 19N, Range 5W
Revised Area of Interest

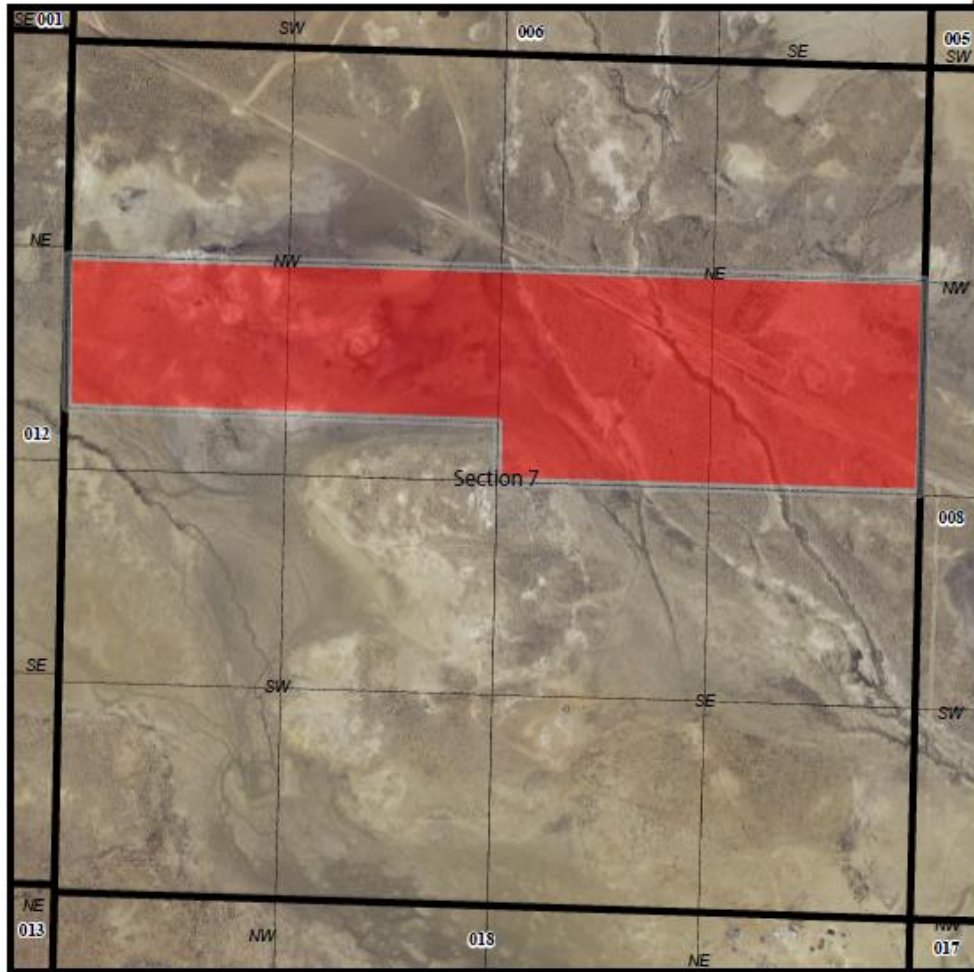

1:10,000