

La Ventana and Padilla Mine Safeguarding Project

The Abandoned Mine Land Program is proposing to implement mine safeguarding measures at the former La Ventana and Padilla mines. Safeguarding measures are needed for the safety of anyone accessing the area of the mines. Environmental reviews of the project including cultural and biological resources evaluations, a bat survey and assessment, and tribal consultation have been completed as part of supporting documentation for the preparation of a Categorical Exclusion (CE).

Project

The proposed project area is located approximately 7.5 miles south of Cuba, in Sandoval County, New Mexico, on privately-owned land as well as land administered by the Bureau of Land Management. The proposed project includes the backfilling of one subsidence and airflow/culvert or bat compatible closures at four more mine features. The Area of Potential Effects (APE) is based on proposed project activities and encompasses approximately 67 acres.

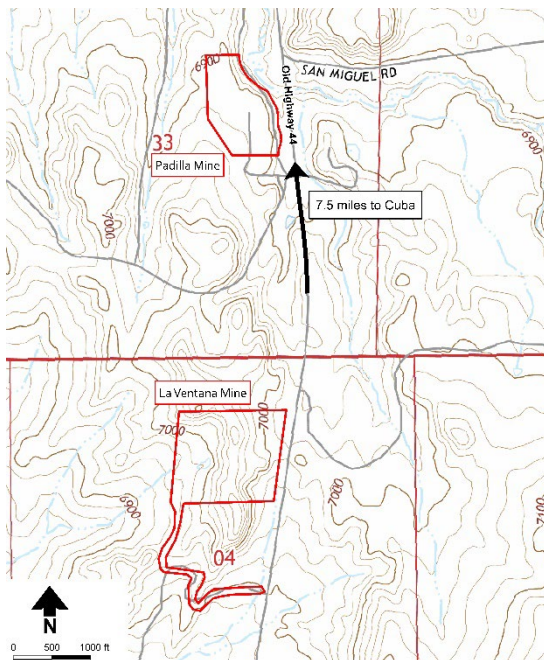

You are invited to review the draft CE and provide comments on the project at the following link:
<https://www.emnrd.nm.gov/mmd/public-notices/> Public comments will be accepted until August 31, 2024. You may contact James Hollen at james.hollen@emnrd.nm.gov or (505) 231-8332 with questions, comments, or for more information.

Thank you for your interest.

Abandoned Mine Land Program